



Table of Contents

1. Index (this page)
2. Guide Page
3. [St Thomas' Hospital](#)
4. [Royal London Hospital](#)
5. [St Bart's / Bartholomew's Hospital](#)
6. [King's College Hospital, Denmark Hill](#)
7. [Royal Brompton Hospital](#)
8. [Harefield Hospital](#)
9. [Frimley Park](#)
10. [Royal Surrey County Hospital](#)
11. [St Peter's, Chertsey](#)
12. [Princess Royal University Hospital, Orpington](#)
13. [St Helier Hospital, Carshalton](#)
14. [Guy's Hospital](#)
15. [Health Services laboratory](#)
16. [Ashford Hospital Surrey](#)
17. [Hillingdon Hospital](#)
18. [Epsom General Hospital](#)
19. [Charing Cross Hospital](#)
20. [West Middlesex University Hospital](#)
21. [Chelsea & Westminster Hospital \(Milk\)](#)
22. [Croydon University Hospital](#)
23. [Darent Valley Hospital](#)
24. [Kingston Satellite Dialysis Unit](#)
25. [Kingston Hospital \(Milk\)](#)
26. [East Surrey Hospital](#)
27. [Great Ormond Street Hospital](#)
28. [The London School of Hygiene & Tropical Medicine \(Keppel Street\)](#)
29. [St Mary's Hospital, Paddington \(Milk\)](#)
30. [St George's Hospital \(Milk\)](#)
31. [Whipps Cross University Hospital](#)
32. [University Hospital Lewisham](#)
33. [University Hospital Lewisham \(Milk\)](#)
34. [Queen Charlotte's and Chelsea Hospital \(Milk\)](#)
35. [The Royal Marsden Hospital, Surrey \(Sample\)](#)
36. [Center For Molecular Pathology, Surrey \(The Royal Marsden Hospital\)](#)
37. [NHSBT, Colindale](#)
38. [Doctor's Lab](#)
39. [Queen Elizabeth Hospital](#)
40. [Changelog](#)

Please send feedback & inaccuracies to: press@servssl.org.uk



Name of Hospital or site



Key Information

Pathology: Pathology building & floor

Postcode:

Parking W3W: ///What3Words words here

Lat & Long: /

Pathology Tel:

Google Maps link here

If site is in CC or ULEZ Zone

What3Words is available as on your browser and as an app. Using the app you can scan the words above

<https://apps.apple.com/gb/app/what3words/id657878530>

https://play.google.com/store/apps/details?id=com.what3words.android&hl=en_GB&gl=US

<https://what3words.com/daring.lion.race?redirect=true>

Photo of the site

Google Map photo

Parking Instructions

Instructions on where to park a car and a bike

Video: Video link to get to parking



Bike Parking



Car Parking

Access Instructions

Instruction on how to get to pathology from parking

Photo of of hospital map

Link to the map of the hospital



St Thomas' Hospital



Key Information

Pathology: North Wing, 5th floor
Postcode: SE1 7EH
Parking W3W: ///farm.error.rocket

Lat & Long: 51.499860 / -0.118620
Pathology Tel: 0207 188 9613

<https://goo.gl/maps/SGSfZDBqw5ovKzaH9>

CC Zone | ULEZ Zone

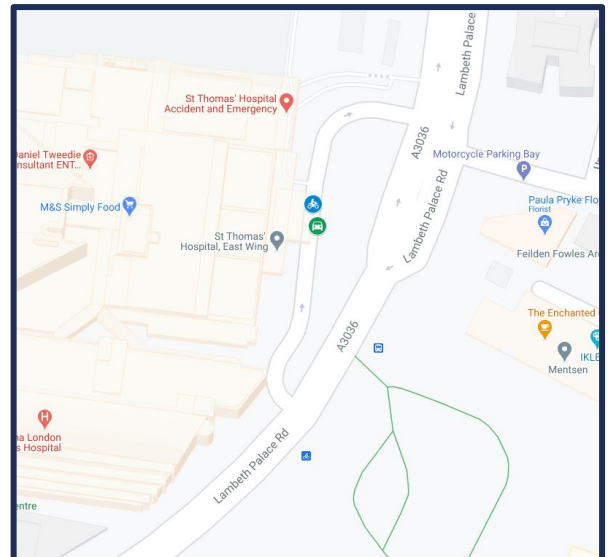
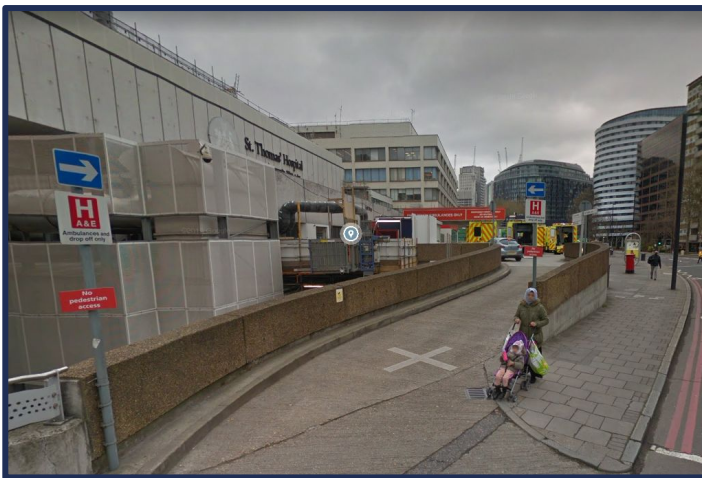

Parking Instructions

Follow directions up ramp for "Emergency Ambulances Only". Park on right side of ambulance area, with blood sign displayed

Video: <https://youtu.be/siPyh0RQXVk>

 **Bike Parking**
 **Car Parking**

Access Instructions

Follow raised walkway to right to main entrance. Go through main entrance, then right towards cafe. Enter North Wing and take first set of lifts (set A) to 5th floor, using the phone on the left if doors are locked. Pathology door outside lift doors

<https://www.guysandstthomas.nhs.uk/resource/s/location-maps/st-thomas-map.pdf>



Royal London Hospital



Key Information

Pathology: Pathology and Pharmacy building, 4th floor

Postcode: E1 1BB

Parking W3W: ///rested.courier.visual

Lat & Long: 51.51878 / -0.06017

Pathology Tel: 0203 246 0344

<https://goo.gl/maps/vbmaj9LXKtyE92xZ9>

ULEZ Zone

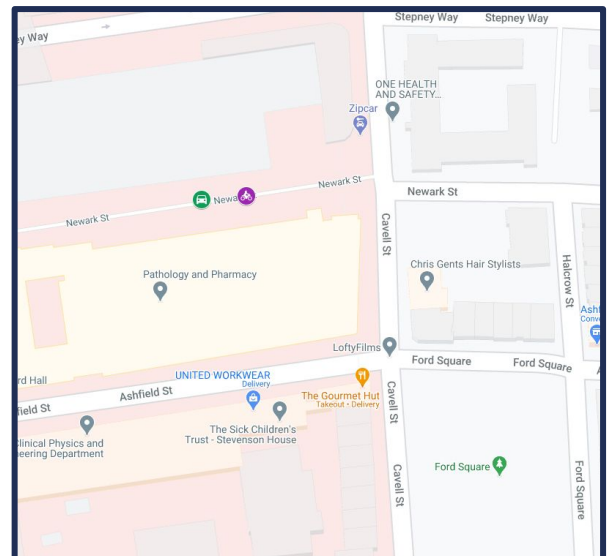
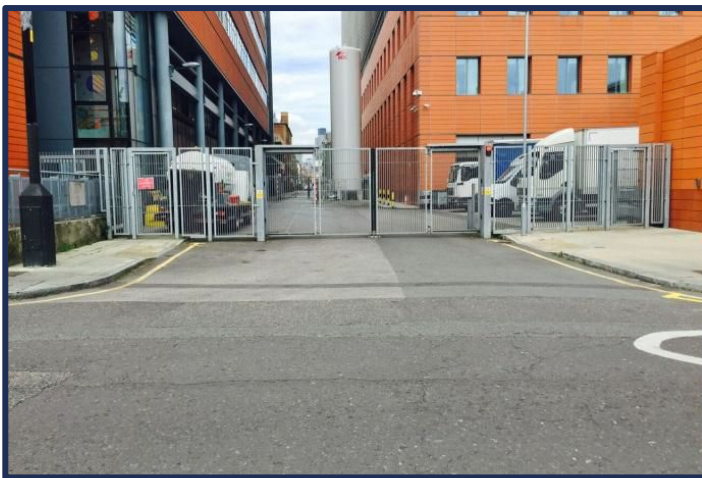

Parking Instructions

Use intercom on right wall of gate to enter site. Drive up to 2nd gate and it will automatically open. Park bike opposite P&P building entrance or in bays on right 30m after 2nd gate if in car. Video: <https://youtu.be/-laNGYAys6s>



**Bike Parking
Car Parking**

Access Instructions

Use intercom on left wall of P&P entrance, ask security directly in front for keycard. Go to 4th floor and open door on immediate left with keycard.

<https://www.yumpu.com/en/document/read/38423499/site-map-of-the-royal-london-hospital-barts-health-nhs-trust>





St Bart's / Bartholomew's Hospital



Key Information

Pathology: North Wing, 2nd floor
Postcode: EC1A 7BE
Parking W3W: [///signal.gaps.drove](http://signal.gaps.drove)

Lat & Long: 51.51.51715 / -0.10007
Pathology Tel: 0203 465 6130

<https://goo.gl/maps/cSDxE17p5TGkrDNb8>

CC Zone | ULEZ Zone

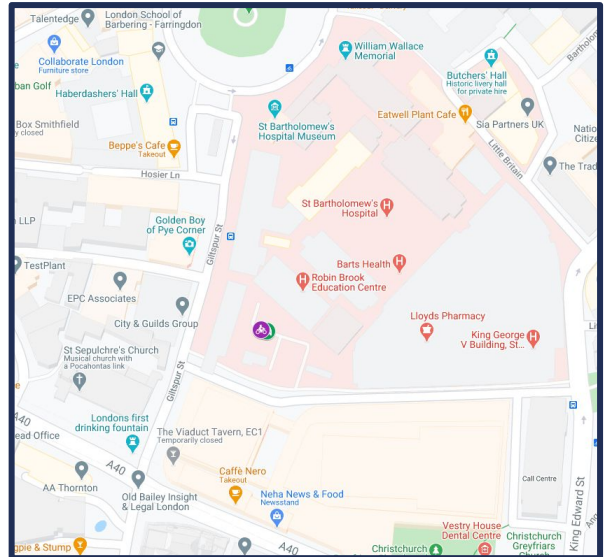

Parking Instructions

Enter from Gitspur St into archway, take first left into car park. Turn left past barrier and park in courier bay

Video: <https://youtu.be/-G0QFV687QA>

Access Instructions

From car park, follow wall to left into covered alleyway, turning right. Enter building via double doors OR lift in alcove on left to 2nd floor. Use intercom on right of door

<https://www.bartshealth.nhs.uk/download.cfm?doc=docm93ijim4n735>



Bike Parking
Car Parking





King's College Hospital, Denmark Hill



Key Information

Pathology: Bessemer Wing, ground floor
Postcode: SE5 9RS
Parking W3W: [///shades.catch.labels](http://shades.catch.labels)

Lat & Long: 51.46728 / -0.09279
Pathology Tel: 0203 299 3240
Bleep: 291

<https://goo.gl/maps/P8LFL5yhNuhnF9nt9>

ULEZ Zone

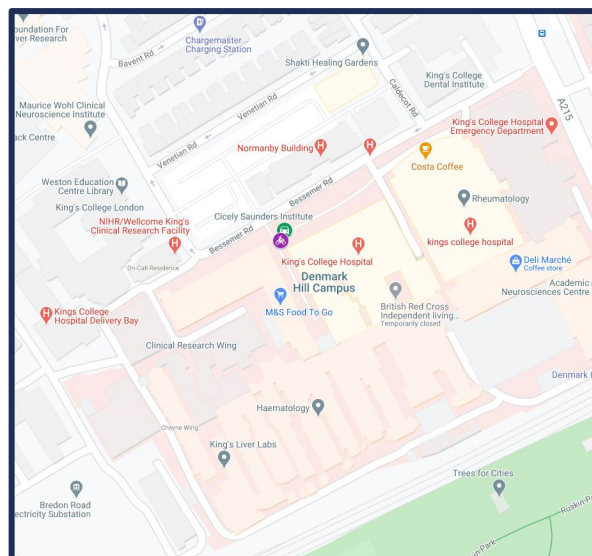
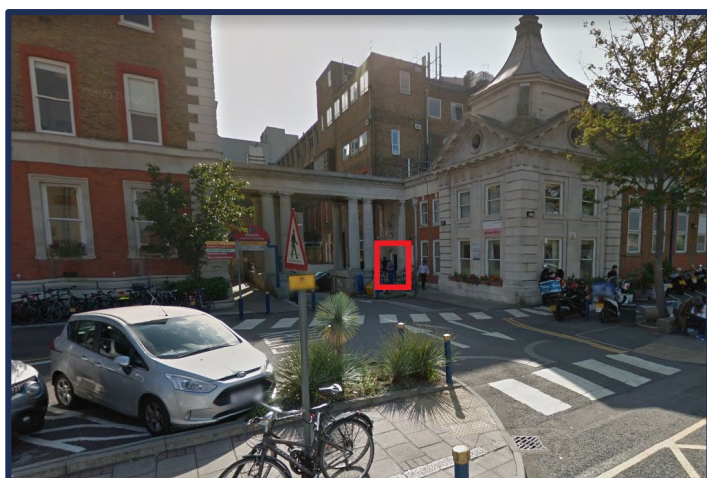

Parking Instructions

From Coldharbour Ln, turn into Caldecot Rd. At end of road, turn right, then after zebra crossing turn left to main entrance of hospital. Park bike at end of road, or car in a bay

Video: <https://youtu.be/M-uvVDVzqqo>

 **Bike Parking**
 **Car Parking**

Access Instructions

Enter Bessemer Wing from parking. After automatic doors, use intercom on right of door. Walk roughly 15m and enter door on right

<https://www.kch.nhs.uk/Doc/mi%20-%20027.12%20-%20king's%20campus%20map.pdf>





Royal Brompton Hospital



Key Information

Pathology: Sydney Wing, ground floor
Postcode: SW3 6NP
Parking W3W: ///pits.jazzy.danger

Lat & Long: 51.48906 / -0.17076
Pathology Tel: 020 7352 8121

<https://goo.gl/maps/JDhgoCqN5DAAipMb6>

ULEZ Zone

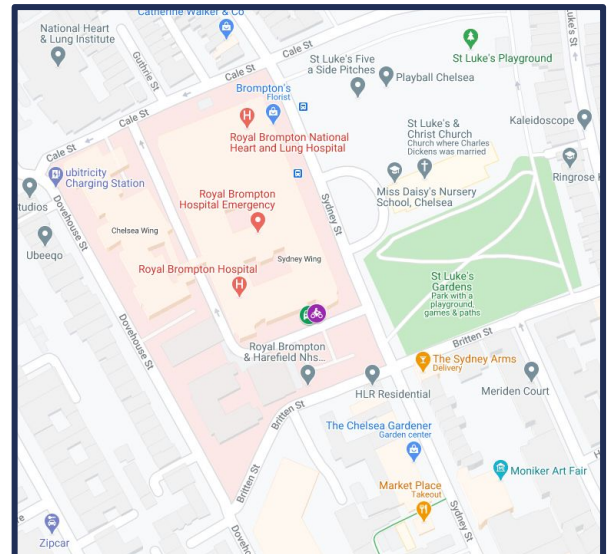

Parking Instructions

Park outside main entrance in yellow hatched box

Video: <https://youtu.be/OoTrFeFOkfl>



Bike Parking
Car Parking

Access Instructions

Use video intercom left of the door. Once in, tell security you're delivering blood, then walk through double doors and turn slight right. Keep going straight at junction to locked door, and use intercom on right. Once in, walk straight for ~20m

No map available yet

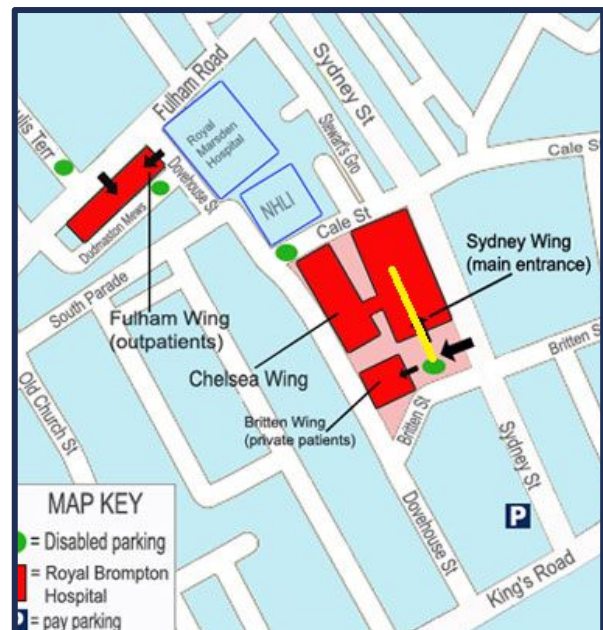



Harefield Hospital



Key Information

Pathology: (own building)
Postcode: UB9 6JH
Parking W3W: ///ledge.expert.photos

Lat & Long: 51.607777 / -0.482205
Pathology Tel: 01895 828732

<https://goo.gl/maps/kX7SyyR42dU8XnJMA>

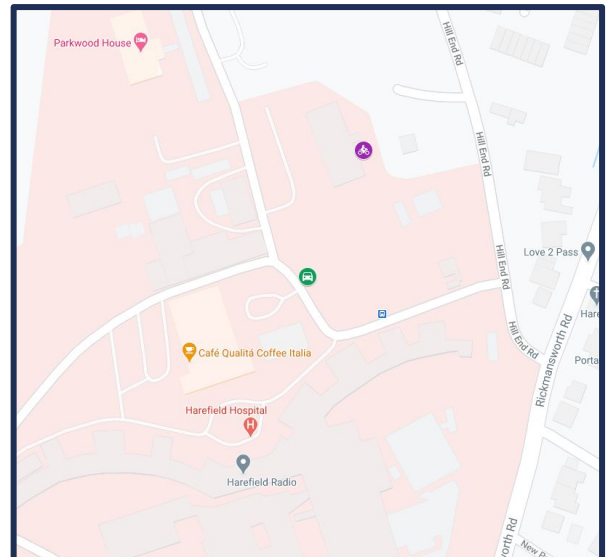

Parking Instructions

Turn right at mini roundabout in hospital grounds,
Bikes: ride up to end of road on immediate right
after roundabout, sign says "I&T Department" -
above. Cars: take second right - blue line
Video: <https://youtu.be/wMz2hPGRPyA>



Bike Parking
Car Parking

Access Instructions

From car, walk up road signed "I&T Department
to end of road. Ring all 3 intercoms for
attention.

No map available

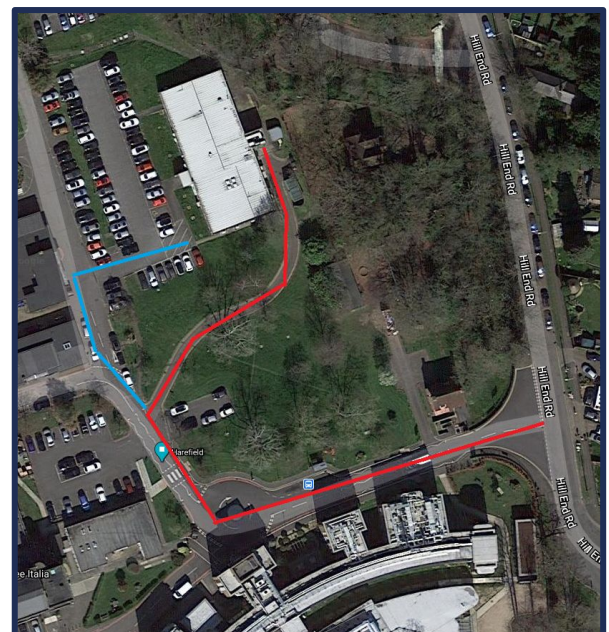



Frimley Park Hospital



Key Information

Pathology: Blue Street, ground floor
Postcode: GU16 7UJ
Parking W3W: ///yacht.dormant.heeding

Lat & Long: 51.31936 / -0.74046
Pathology Tel: 01276 604408

<https://goo.gl/maps/9NM9XCtVhHLb1QQR9>

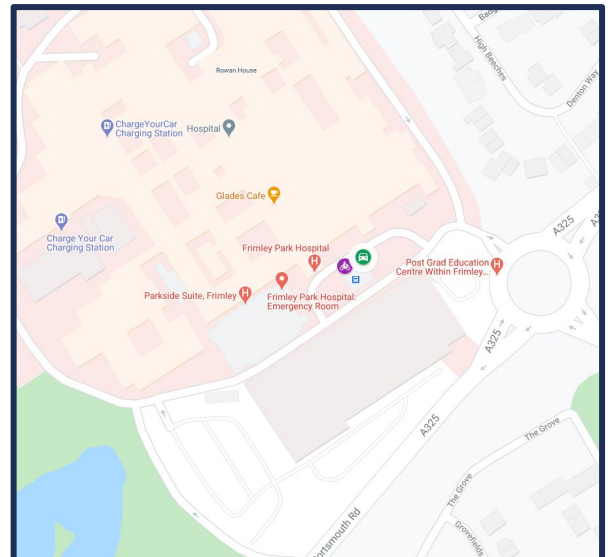

Parking Instructions

Cars & Bikes: Park outside main entrance at drop-off point

Video: <https://youtu.be/3PNPFxDTi00>

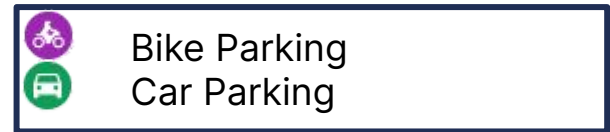

Access Instructions

Main Entrance: Walk straight to "Yellow Street" then turn right. Continue to end then turn left on to "Blue Street". Pathology is on left, use phone on right of door

<https://www.fhft.nhs.uk/media/3514/fph-site-map-2018.pdf>

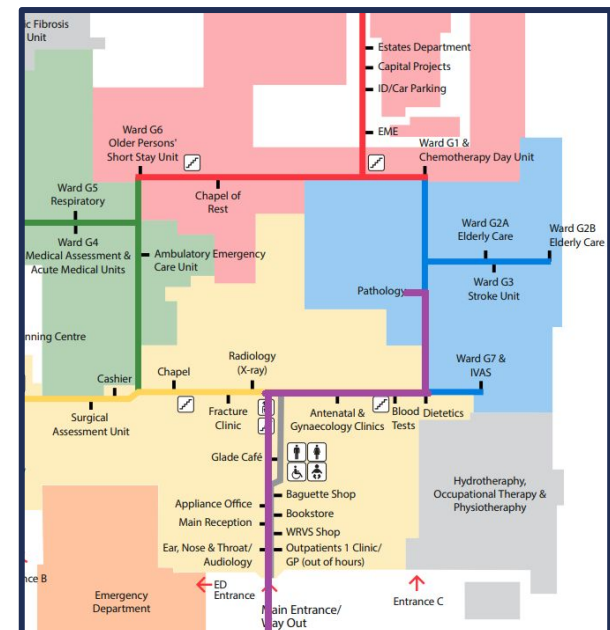



Royal Surrey County Hospital



Key Information

Pathology: Clinical Lab, Level B
Postcode: GU2 7XX
Parking W3W: ///chose.stop.deny

Lat & Long: 51.24103 / -0.60743
Pathology Tel: 01483 464061

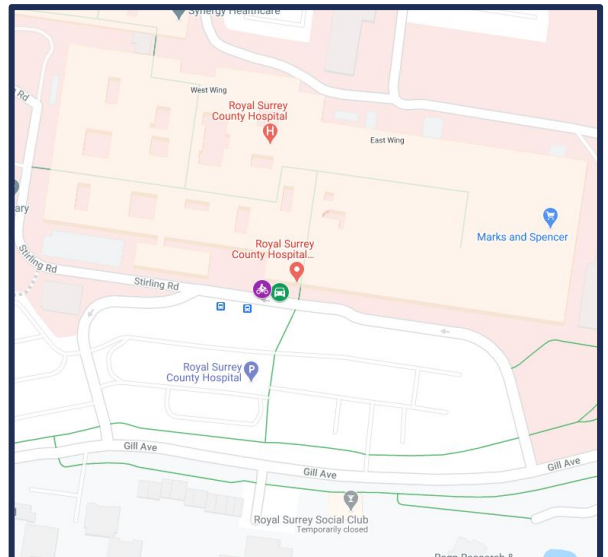

<https://goo.gl/maps/ayKxGb3ZjHK7cNPz8>



Parking Instructions

Use yellow hatched area just beyond main entrance

Video: <https://youtu.be/INwyoTn1FD4>

 Bike Parking
 Car Parking

Access Instructions

Use main entrance. Go straight through main doors to end, then turn right. After 50m use door on left with small SERV sign. Knock on door to get attention

<https://maps-surrey.com/royal-surrey-county-hospital-map#&gid=1&pid=1>

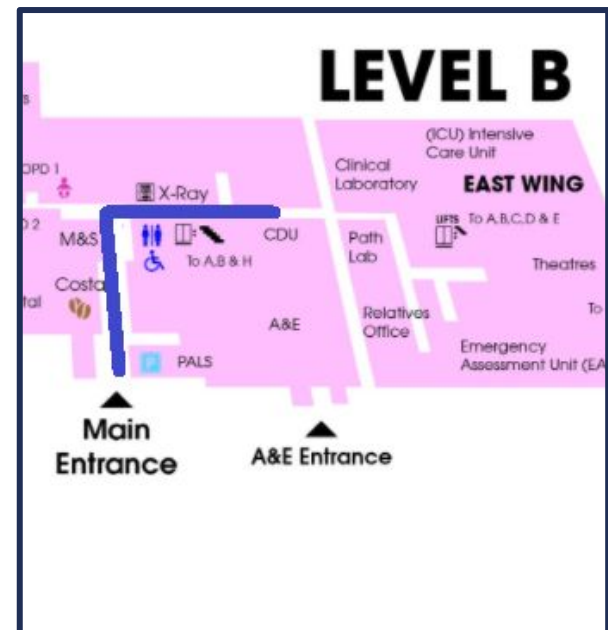



Key Information

Pathology: Lower floor
Postcode: KT16 0PZ
Parking W3W: ///salsa.gears.noble

Lat & Long: 51.37893 / -0.52859
Pathology Tel: 01932 723412

<https://goo.gl/maps/BsdXUAMcci8mdna99>

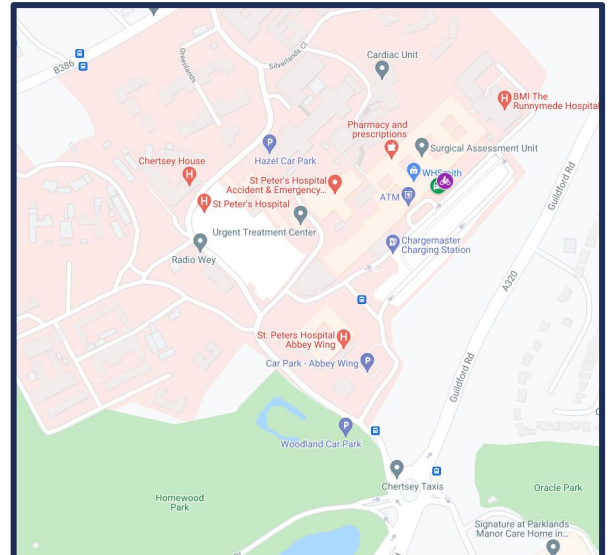

Parking Instructions

Follow signs to A&E at roundabout and follow road right. Coming up the hill take the road on right signed "main entrance". Go past main entrance, and take the left. Park in "Pathology only" bay
Video: <https://youtu.be/qDBww3bdkjm>

 **Bike Parking**
 **Car Parking**

Access Instructions

At the left end of the wall, press bell to gain attention of pathology staff, or knock on the windows at highlighted in red above.

<https://www.ashfordstpeters.nhs.uk/hospital-site-maps>

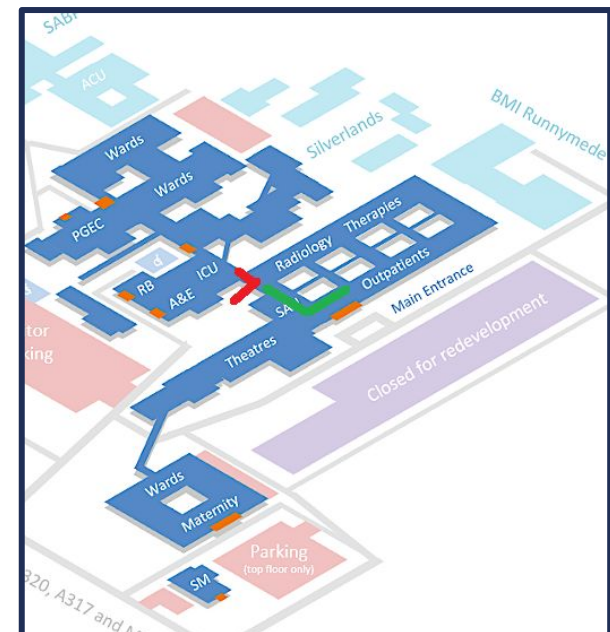



Princess Royal University Hospital, Orpington



Key Information

Pathology: South Wing, 2nd floor
Postcode: BR6 8ND
Parking W3W: [///glove.only.covers](http://glove.only.covers)

Lat & Long: 51.36617 / 0.058958
Pathology Tel: 01689 864329

<https://goo.gl/maps/BctWgtTtkytrP5vy6>

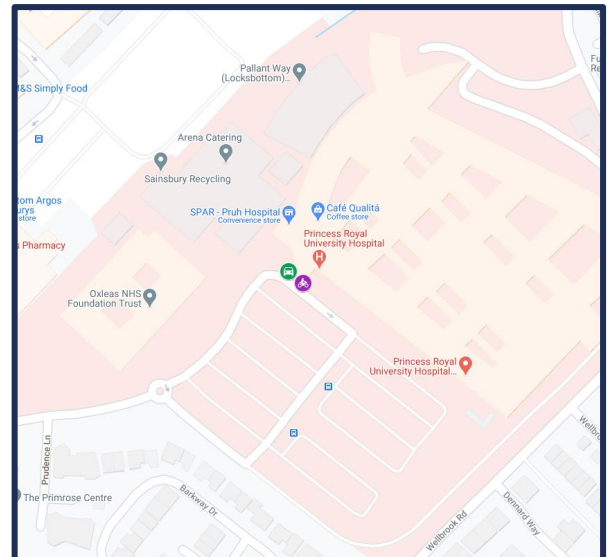

Parking Instructions

Park outside main entrance if open, or by A&E if not

Video:



Access Instructions

Main Entrance: Go straight and use lift on right to 2nd floor. Turn right through corridor, pathology is on left, signed "Specimen Delivery"

A&E: Go through A&E to end, then turn left. Continue down long corridor until to end, turn left and use lift, and follow instruction above

<https://pruh.kch.nhs.uk/media/PRUH-map-august-2018.pdf>

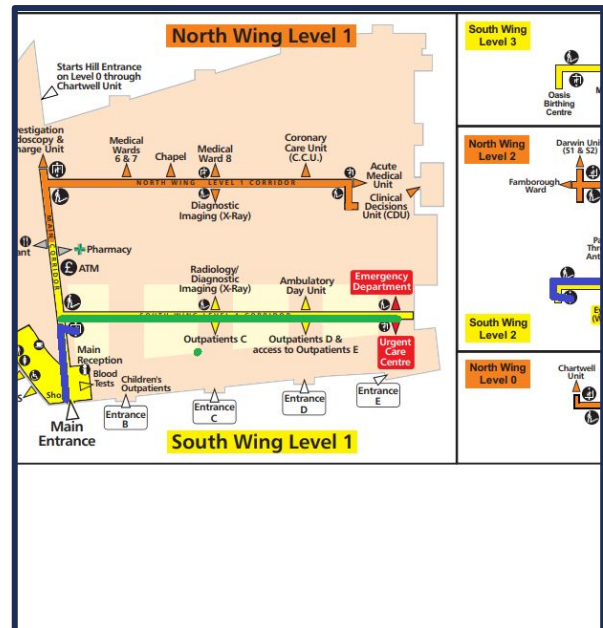



St Helier Hospital, Carshalton



Key Information

Pathology: Block D, 1st floor
Postcode: SM5 1AA
Parking W3W: [///lung.foster.easy](http://lung.foster.easy)

Lat & Long: 51.37999/ -0.18278
Pathology Tel: 07887212112

<https://goo.gl/maps/DhFg3vi1v6AKHrgp6>

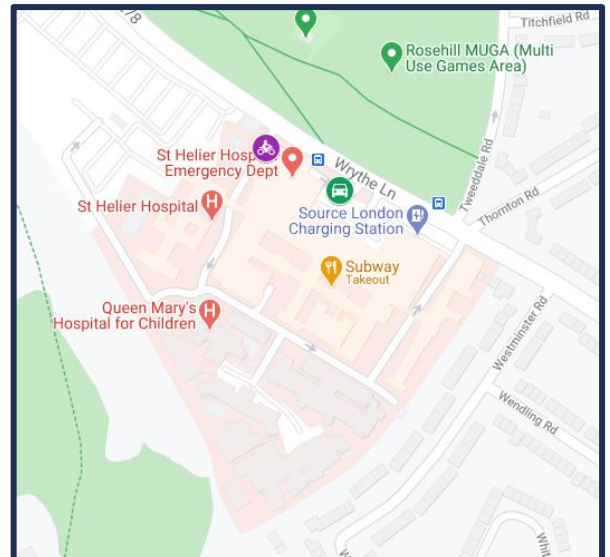

Parking Instructions

Bikes: Park outside, between A&E and UTC
Cars: Park outside Renal Dept

Video: <https://youtu.be/vQqnX4BZacA>

Access Instructions

Enter Emergency Dept, ask to be buzzed in. At main corridor, turn left into Block C. In Block C, take stairs on left to 1st floor. Turn left and take walkway to Block D. Use phone to call pathology at end of walkway.

<https://www.epsom-sthelier.nhs.uk/download.cfm?doc=docm93jijm4n485.pdf&ver=30492>

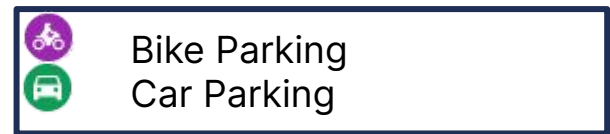



Guy's Hospital



Key Information

Pathology: Southwark Wing, 4th floor
Postcode: SE1 9RT
Parking W3W: ///posed.cheese.alive

Lat & Long: 51.5032 / -0.08795
Pathology Tel: 020 7188 7188

<https://goo.gl/maps/6c6kemxvmMQvg2rL8>

CC Zone | ULEZ Zone

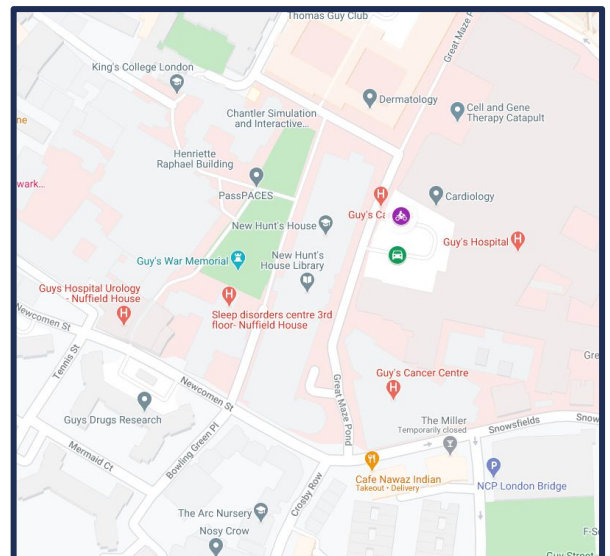

Parking Instructions

Car: Drop-off section outside main entrance
Bike: By glass wall on left outside main entrance

Video: <https://youtu.be/0IOLgHZwsR8>

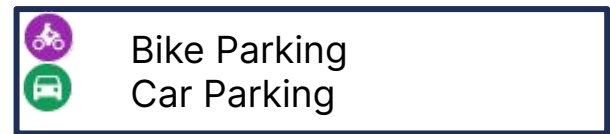

Bike Parking
Car Parking

Access Instructions

Use "B" lifts on left of main entrance to go to 4th floor. Turn right out of lift lobby, then left at corridor. Follow to doorway on left with sign for "Atrium 1". Go down corridor to end. If door at end is locked, use phone on right of door

<https://www.guysandstthomas.nhs.uk/resource/s/location-maps/guys-map.pdf>

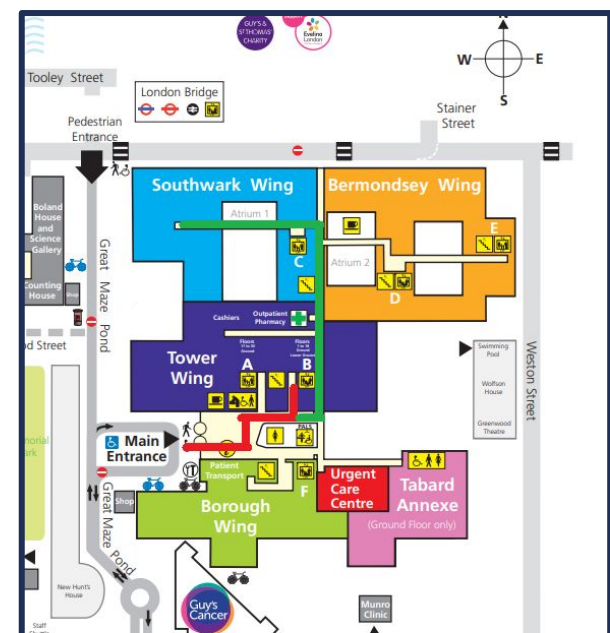



Health Services Laboratory



Key Information

Pathology: Ask reception - floor varies
Postcode: W1T 4EU
Parking W3W: [///analogy.reap.supporter](http://analogy.reap.supporter)

Lat & Long: 51.5216 / -0.13606
Pathology Tel: -

<https://goo.gl/maps/NNtdSqYhqXnzpe848>

CC Zone | ULEZ Zone

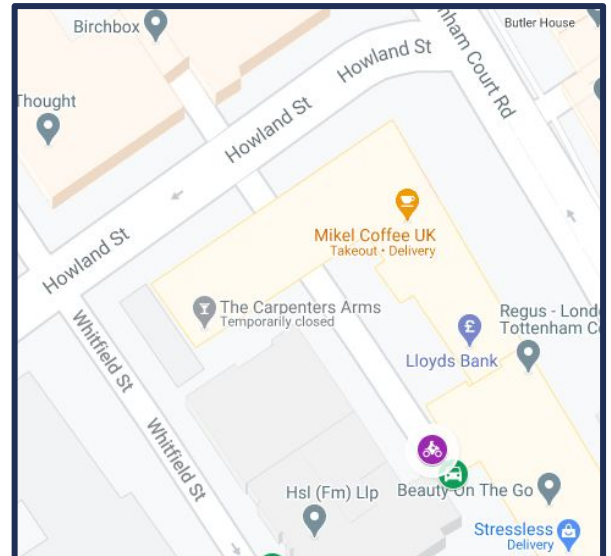

Parking Instructions

Cars & Bikes: Park in alleyway

See also: *Doctor's Lab documentation*
Video:

Access Instructions

Go to Howland Mews East, go to door on left, use doorbell with camera.

No map available



Bike Parking



Car Parking

No map available



Ashford Hospital Surrey



Key Information

Pathology:
Postcode: TW15 3AA
Parking W3W: ///minus.title.vital

Lat & Long: 51.44406 / -0.47299
Pathology Tel: 01784 884488

<https://goo.gl/maps/NuCQUqCvyLqgojvy5>

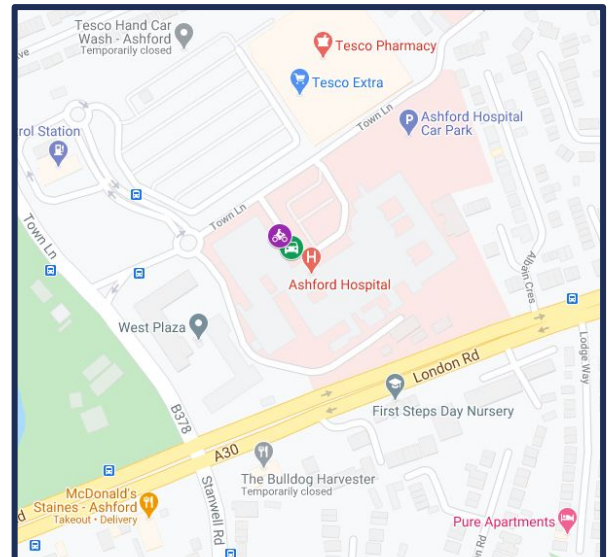

Parking Instructions

Cars and Bikes: Just right of and past main entrance

Video:

Access Instructions

Enter main entrance. Go through 2 automatic doors, continue through another double doors, and use intercom. Inform security, and they will escort you to Wordsworth Ward, then they will escort you out.

<https://www.ashfordstpeters.nhs.uk/hospital-site-maps>

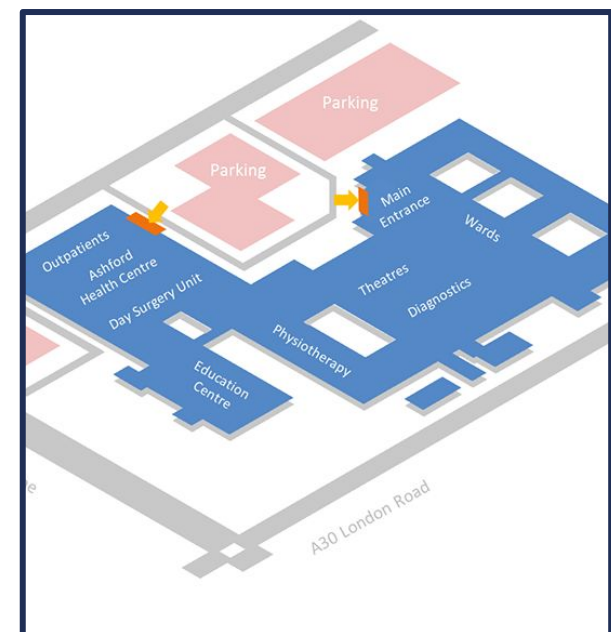
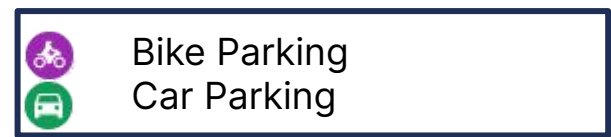



Hillingdon Hospital



Key Information

Pathology: Tower Block, 1st floor
Postcode: UB8 3NN
Parking W3W: ///sands.speaks.warm

Lat & Long: 51.52627 / -0.46126
Pathology Tel: 01895 238282

<https://goo.gl/maps/ke4fWre1G6ATSf929>

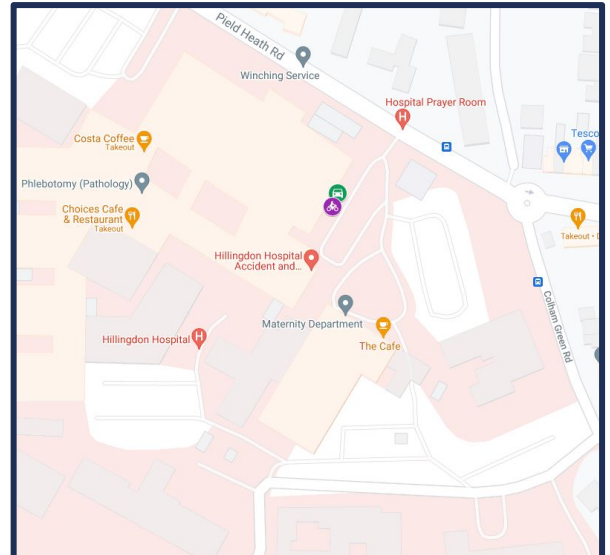

Parking Instructions

Cars and Bikes: Park in drop-off point outside A&E entrance, situated up ramp and past ambulance parking

Video:

 Bike Parking
 Car Parking

Access Instructions

Enter A+E door, proceed down the corridor to the first set of stairs. Goto first floor and turn right. Follow corridor to the specimen reception

https://www.thh.nhs.uk/documents/_Travel/Maps/Hillingdon-Map.pdf

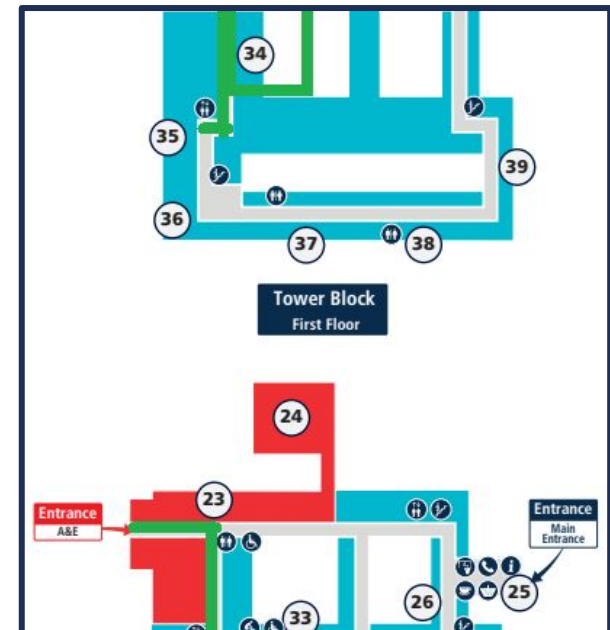



Epsom General Hospital



Key Information

Pathology: Headley Wing, ground floor (Haematology)

Postcode: KT18 7EG

Parking W3W: ///cargo.prop.stream

Lat & Long: 51.32542 / -0.27329

Pathology Tel: 07887212094

<https://goo.gl/maps/wEAkFLSPYA8WMfxq8>

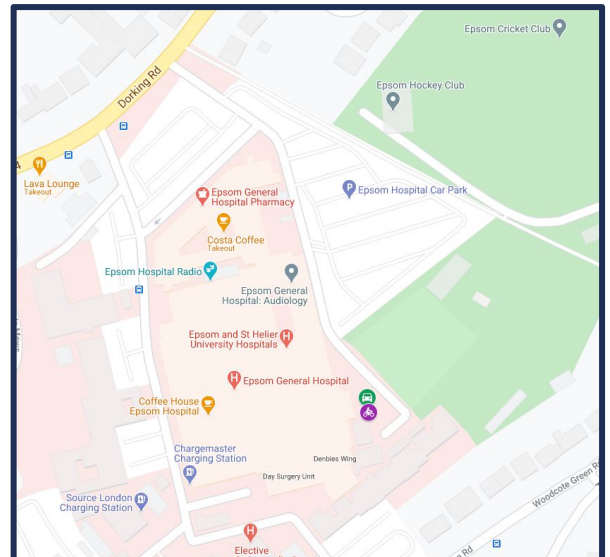

Parking Instructions

Cars & Bikes: Use drop-off bay outside A&E

Video: <https://youtu.be/6XuFueKS1Ng>

Access Instructions

Enter Bradbury Wing and ask security on left to bleep 897 to notify arrival. Follow signs for pathology to Headley Wing. Just inside wing are stairs to pathology lab door. Wait for scientist at door

<https://www.epsom-sthelier.nhs.uk/download.cfm?doc=docm93jjm4n486.pdf&ver=30496>

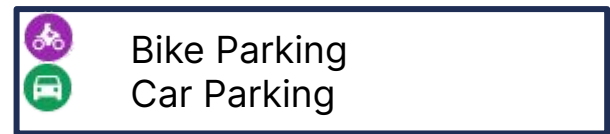

Bike Parking
Car Parking





Charing Cross Hospital



Key Information

Pathology: East Wing, 1st Floor
Postcode: W6 8RF
Parking W3W: ///pints.damp.twin

Lat & Long: 51.48657 / -0.21949
Pathology Tel: 020 3311 1234

<https://goo.gl/maps/G5w1SyadPPnZpT8x9>

ULEZ Zone

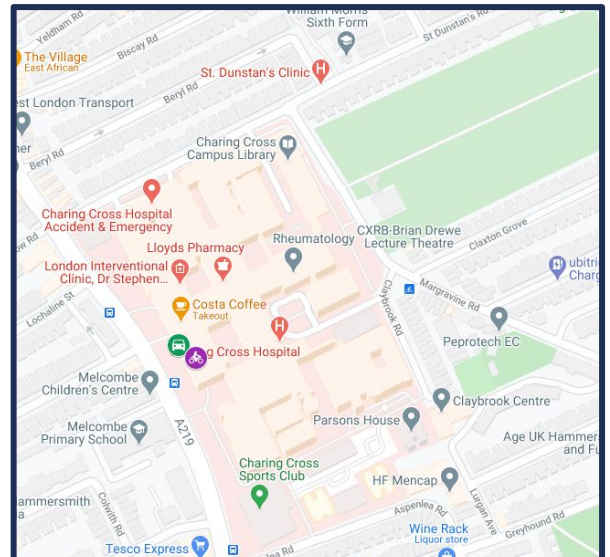
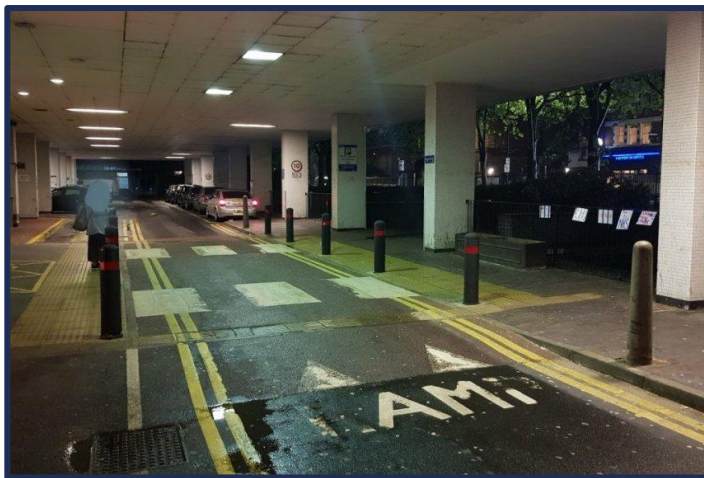

Parking Instructions

Cars and Bikes: Use bays outside main entrance

Video: https://youtu.be/sjC_JTsUt08

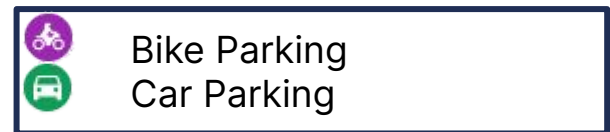

Access Instructions

Enter main entrance using intercom between doors if needed. Go Straight and take escalators on left up to 1st floor. Turn left twice to East Wing, going left around lifts. At end of corridor turn left and use intercom

<https://www.imperial.nhs.uk/~media/website/locations/charing-cross-hospital/charing-cross.pdf?la=e>

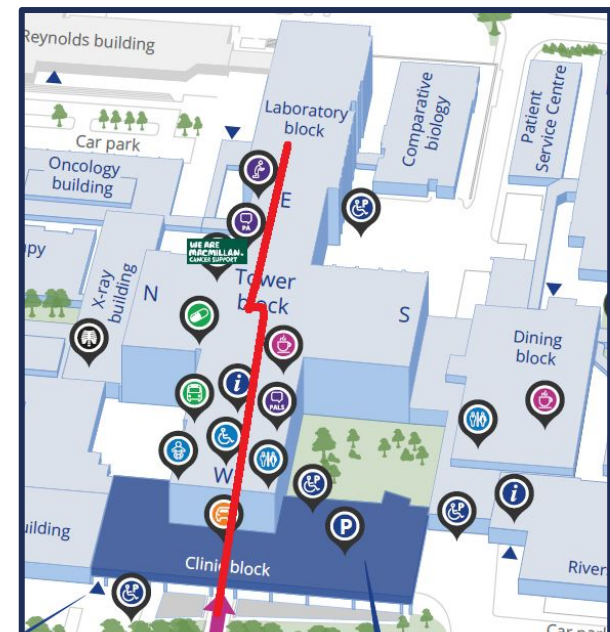



West Middlesex University Hospital



Key Information

Pathology: East Wing, 1st floor
Postcode: TW7 6AF
Parking W3W: [///feared.coats.opera](http://feared.coats.opera)

Lat & Long: 51.47406 / -0.32618
Pathology Tel: 020 8560 2121

<https://goo.gl/maps/u9suDDSNcQaLwE8N7>

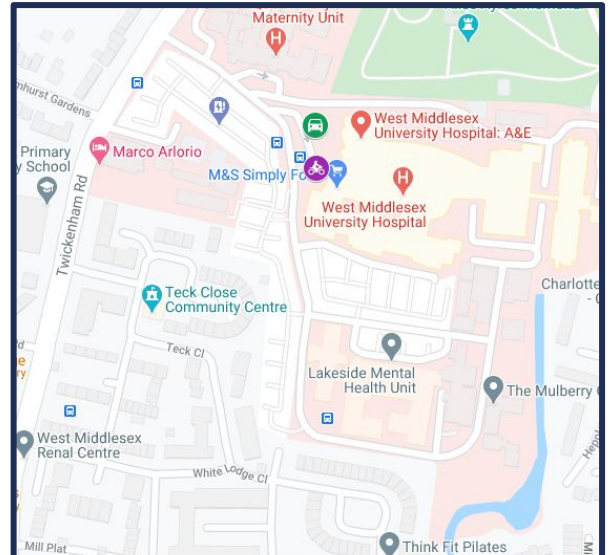

Parking Instructions

Cars: Park in Pickup/Drop off" area
Bikes: Park past bollard next to M&S window

Video:

Access Instructions

Enter main entrance and continue straight, entering East Wing. In East wing, take lift or stairs to 1st floor. On 1st turn right, and use intercom. Once through blood transfusion is 3rd right. Use buzzer straight from pathology door if required.

<https://www.chelwest.nhs.uk/your-visit/getting-here/links/west-middlesex-university-hospital-site-map>

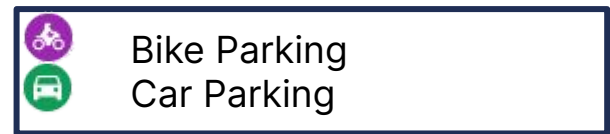



Chelsea & Westminster Hospital (Milk)



Key Information

NICU: 3rd floor
Postcode: SW10 9NH
Parking W3W: [///spoke.slowly.lands](http://spoke.slowly.lands)

Lat & Long: 51.48423 / -0.18145
Pathology Tel: 020 3315 8000

<https://goo.gl/maps/ZeQQU41TWw2D6QLF6>

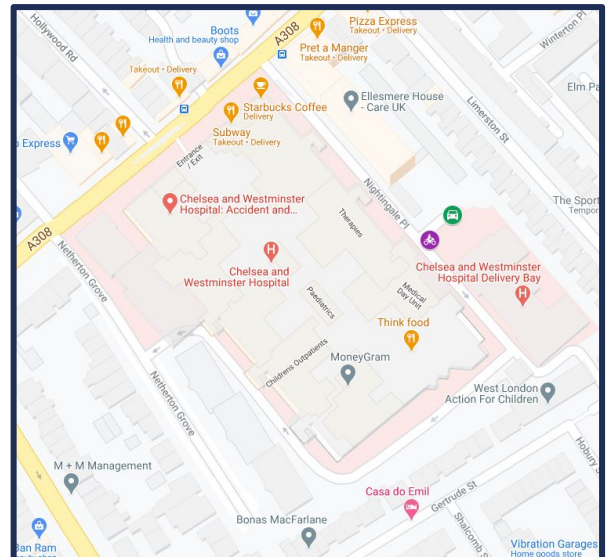

ULEZ Zone



Parking Instructions

Cars: Use underground car park in Ellemere House SW10 9TN
Bikes: park alongside seating area pavement

Video:

Bike Parking
Car Parking

Access Instructions

Enter via main entrance on Fulham Road, obtain pass from reception. Go up escalator, U-turn right and look for NICU sign. Turn left then right to get to lifts to 3rd floor

https://www.chelwest.nhs.uk/your-visit/getting-here/links/Chelsea-and-Westminster-Hospital-Site-Map.pdf/at_download/file





Croydon University Hospital



Key Information

Pathology: 2nd floor
Postcode: CR7 7YE
Parking W3W: [///plan.charge.note](http://plan.charge.note)

Lat & Long: 51.38958 / -0.11034
Pathology Tel: 02084013466

<https://goo.gl/maps/8nEHhQGACUb4jsZk9>

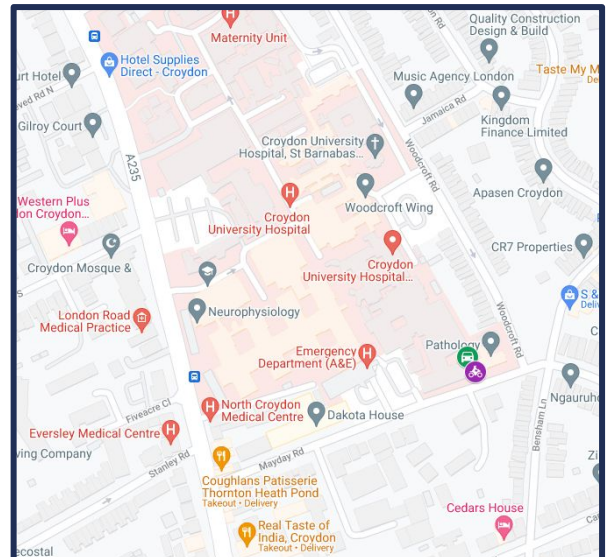

Parking Instructions

Cars & Bikes: Park outside white door, on side street

Video: <https://youtu.be/HQDvfvkpwds>

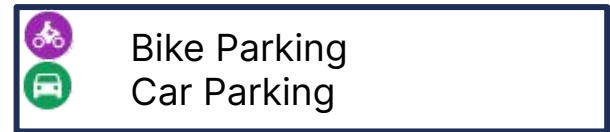

Bike Parking
Car Parking

Access Instructions

Use intercom left of white door. Use stairs to first floor, then walk down corridor. Take the stairs on the left to second floor. Follow direction to pathology lab. Pathology door is on the . *If needed, use internal phone and dial 0 for operator and request bleep BMS on 141*

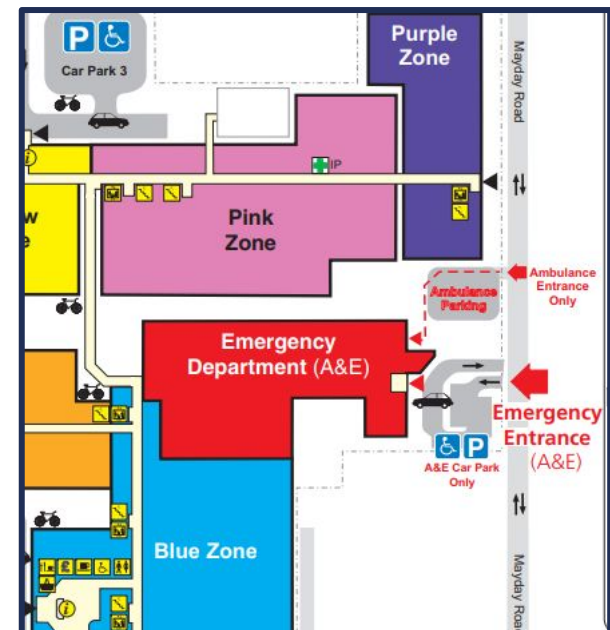

<https://www.croydonhealthservices.nhs.uk/download.cfm?doc=docm93ijjm4n1510.pdf&ver=2614>

Darent Valley Hospital



Key Information

Pathology: 3rd floor
Postcode: DA2 8DA
Parking W3W: ///rash.string.curving

Lat & Long: 51.43507 / 0.258793
 Pathology Tel: 01322 428100

<https://goo.gl/maps/ZQBwhaTxTR69vHqPA>

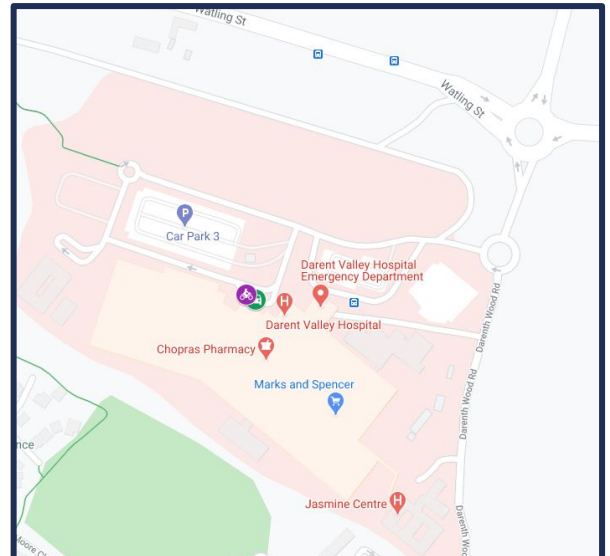

Parking Instructions

Cars & Bikes: Park outside main entrance by ambulances

Video:

Access Instructions

Use main entrance - ring intercom on left of door. Ask security inside to announce to Pathology. Use stairs or lift to go to level 3. Follow signs for "Pathology" along corridor. Pathology is on left - use intercom on left of door.

https://www.dgt.nhs.uk/download_file/view/4337/1395

 Bike Parking
 Car Parking

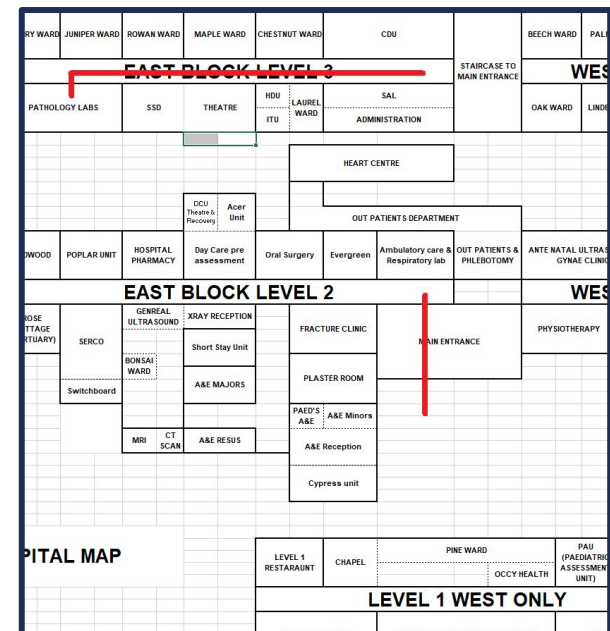



Kingston Satellite Dialysis Unit



Key Information

**Pathology: Manorgate House,
2 Manorgate Road
Postcode: KT2 7AL
Parking W3W: ///king.sleeps.entry**

Lat & Long: 51.41304 / -0.28550
Pathology Tel: 020 8296 4888

<https://goo.gl/maps/UgGiLWiB2pexrzQ7A>

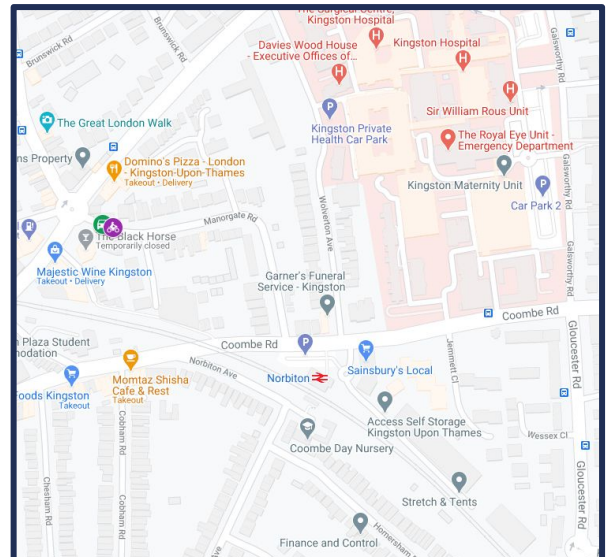

Parking Instructions

Park outside entrance

Video:

Access Instructions

Use intercom on left mark "Dialysis"

No map available



**Bike Parking
Car Parking**

No map available



Kingston Hospital (Milk)



Key Information

Neo-nata: 1st floor
Postcode: KT2 7QB
Parking W3W: ///exchanges.cheek.hatch

Lat & Long: 51.41421 / -0.28202
Pathology Tel: 020 8546 7711

<https://goo.gl/maps/Ch6zqEq98QvCsvQQ8>

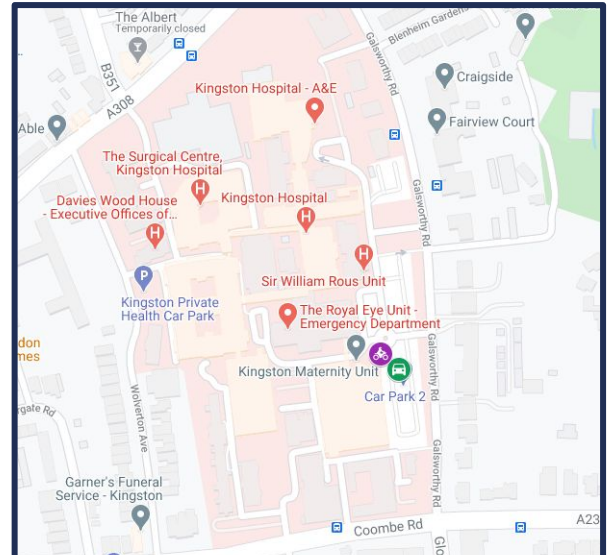

Parking Instructions

Bikes: Park outside main entrance
Cars: Use car park 2

Video:

Access Instructions

Enter maternity wing entrance. Walk to reception desk, turn right and use lift to 1st floor. Request reception to locked open doors. 25m on left is neo-natal unit. Use intercom

<http://www.sexualhealthkingston.co.uk/wp-content/uploads/2015/09/Kingston-Hospital-Site-Map.pdf>

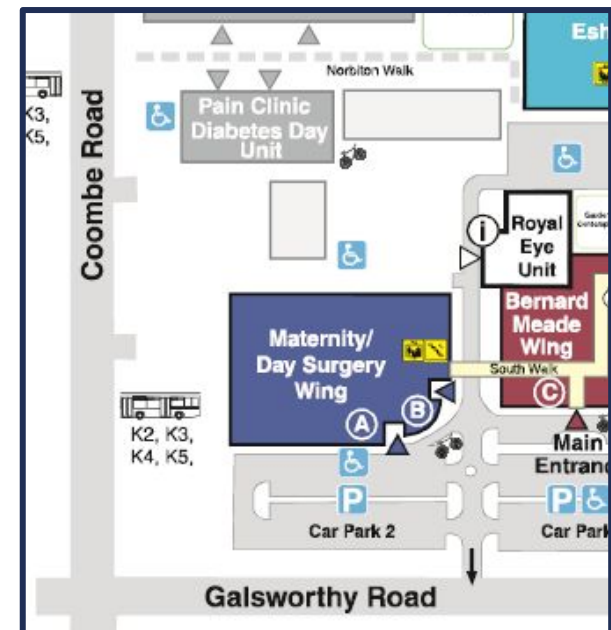



East Surrey Hospital



Key Information

Pathology: Orange, ground floor
Postcode: RH1 5RH
Parking W3W: ///local.churn.violin

Lat & Long: 51.21964/ -0.1635
Pathology Tel: 01737 779489

<https://goo.gl/maps/reYSAdZ6bjaoaiB7>

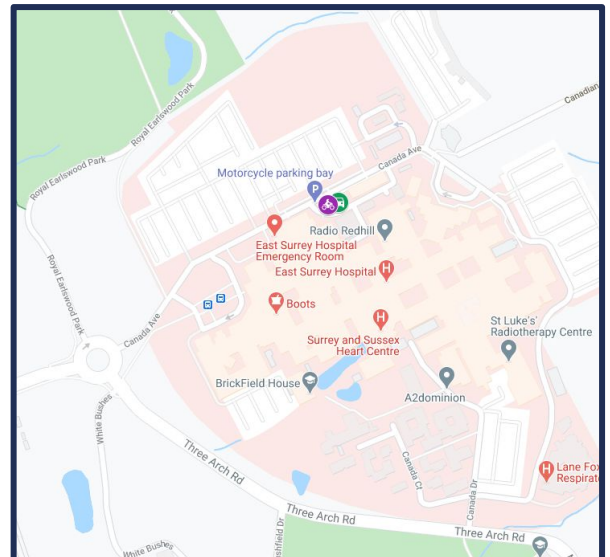

Parking Instructions



Bikes: Park in bike bay after A&E:
Cars: First right after A&E, park out of way

Video:

Access Instructions

Go through alleyway between buildings to door, press intercom to gain access

<https://surreyandsussex.nhs.uk/wp-content/uploads/2018/02/East-Surrey-Hospital-External-Map-Feb-2018.pdf>

 **Bike Parking**
 **Car Parking**

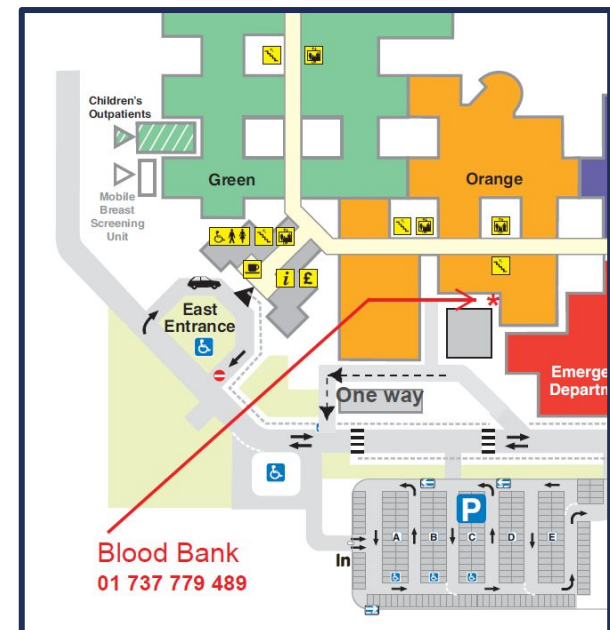



Great Ormond Street Hospital



Key Information

Pathology: Camelia Botnar Laboratories, Level 4

Postcode: WC1N 3JH

Parking W3W: ///maker.legend.mercy

Lat & Long: 51.52248 / -0.12077

Pathology Tel: 020 7405 9200

<https://goo.gl/maps/8wNWA3mnsCbGZxoK8>

CC Zone | ULEZ Zone

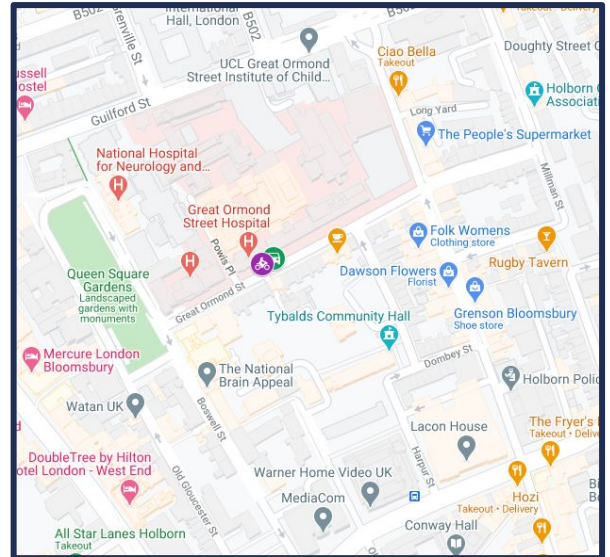

Parking Instructions

Cars & Bikes: Park in yellow zig-zag area outside main entrance

Video:

Access Instructions

TBC

<https://www.gosh.nhs.uk/file/30491/download>

 **Bike Parking**
 **Car Parking**





The London School of Hygiene & Tropical Medicine (Keppel Street)



Key Information

Pathology:
Postcode: WC1E 7HT
Parking W3W: ///forced.keys.former

Lat & Long: 51.52056 / -0.12992
Pathology Tel:

<https://goo.gl/maps/Sj9DCwgPp8hM3uUq5>

CC Zone | ULEZ Zone

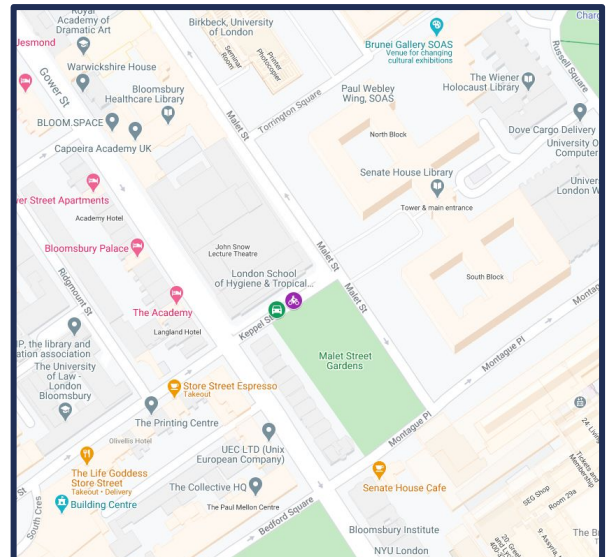

Parking Instructions



Cars & Bikes: Park on street outside entrance

Video:

Access Instructions

Enter entrance on Keppel Steet. Go through metal and glass doors. Speak to security on left, confirm address and addressee with them and leave consignment with security

No map available

 **Bike Parking**
 **Car Parking**

No map available



St Mary's Hospital, Paddington (Milk)



Key Information

NICU: Clarence Memorial Wing, 3rd floor
Postcode: W2 1NY
Parking W3W: [///comet.groups.jokes](http://comet.groups.jokes)

Lat & Long: 51.51714 / -0.1739
Pathology Tel: 020 3312 6666

<https://goo.gl/maps/owkxbfvupJjiNkEW9>

CC Zone | ULEZ Zone

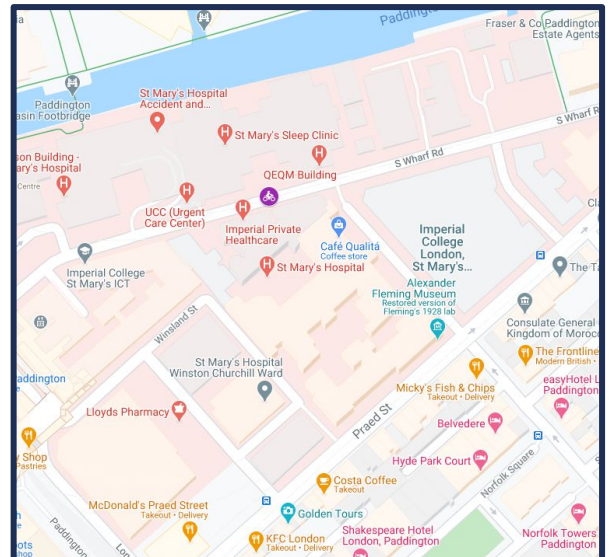

Parking Instructions

Bikes: Park in dedicated motorcycle parking bays on South Wharf Road
Cars:

Video:

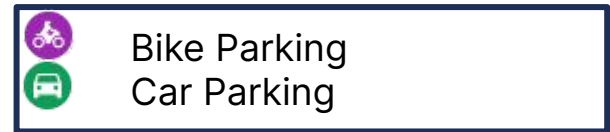

Access Instructions

Walk to Cambridge entrance on Norfolk Place. Go up stairs, turn left until end, then right 20m to lifts. Take lifts to 3rd floor. NICU is on left



<https://www.imperial.nhs.uk/our-locations/st-marys-hospital/site-map> (browser only)



St George's Hospital (Milk)



Key Information

Neonatal: Lanesborough Wing, 1st floor
Postcode: SW17 0QT
Parking W3W: ///noises.period.junior

Lat & Long: 51.42629 / -0.176040
Pathology Tel:

<https://goo.gl/maps/GQQ19kxMDrSrEeNu9>

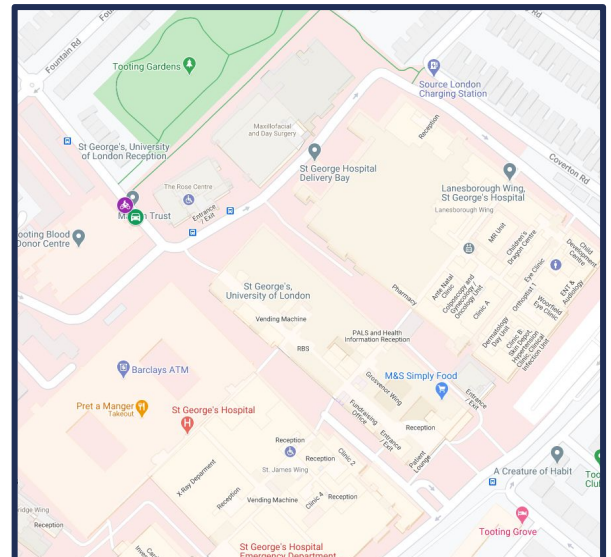

Parking Instructions

Cars & Bikes: Park outside NBS Tooting Hatch

Video:

Access Instructions

Enter via Hunter Wing. Go straight until signs direct left for Lanesborough Wing. In wing, take lifts to 1st floor. Follow signs for neonatal, around to right.

<https://www.stgeorges.nhs.uk/wp-content/uploads/2013/11/sgh-site-map.pdf>

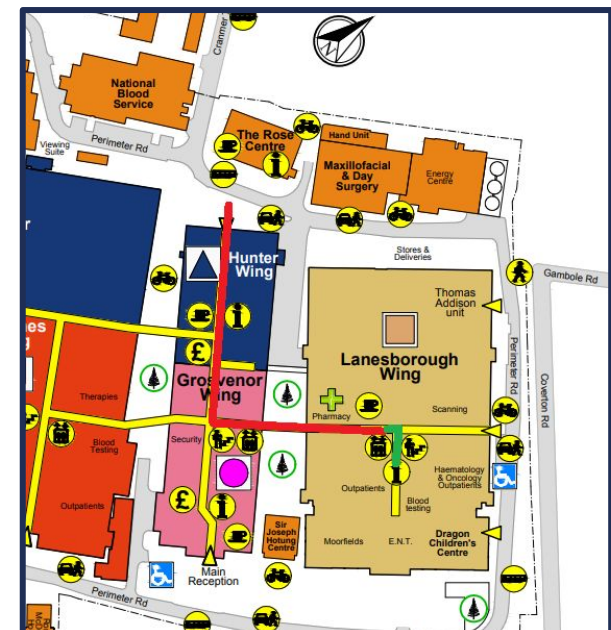
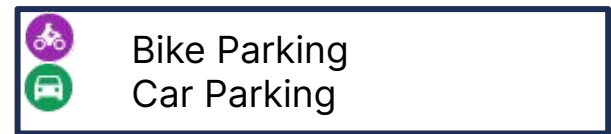



Whipps Cross University Hospital



Key Information

Pathology: Orange Section, 2nd floor
Postcode: E11 1NR
Parking W3W: [///skill.called.fits](http://skill.called.fits)

Lat & Long: 51.57915 / 0.00173
Pathology Tel: 020 8539 5522

<https://goo.gl/maps/4URPbdjSAwMi9dBf6>

ULEZ Zone

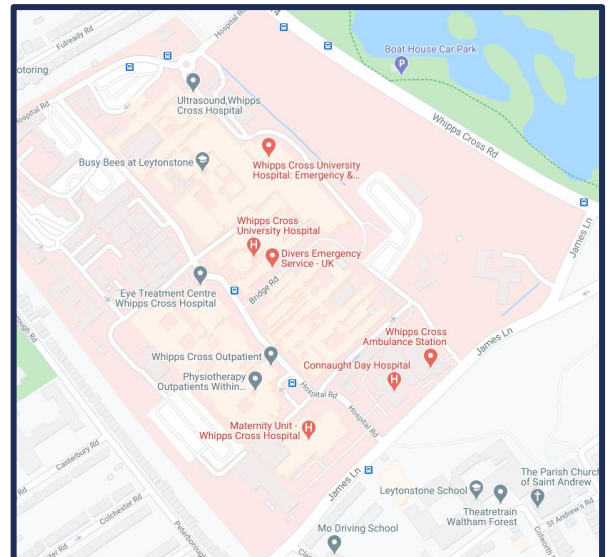

Parking Instructions

Unknown

Video:

Access Instructions

After 10pm: Enter A&E, go through main corridor and turn right. Enter Orange Section, at junction 2 take lifts to 2nd floor.

Pre 10pm: Enter main entrance, at junction 2 ahead take lifts to 2nd floor

<https://www.bartshealth.nhs.uk/download.cfm?doc=docm93jijm4n733.pdf&ver=1037>

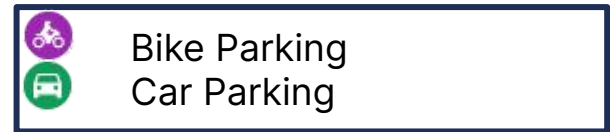



University Hospital Lewisham



Key Information

Pathology: Pink zone, 1st floor
Postcode: SE13 6LH
Parking W3W: ///stage.labels.exams

Lat & Long: 51.45308 / -0.01672
Pathology Tel: 020 8333 3000

<https://goo.gl/maps/mTsQVzhhWbqqEY618>

ULEZ Zone

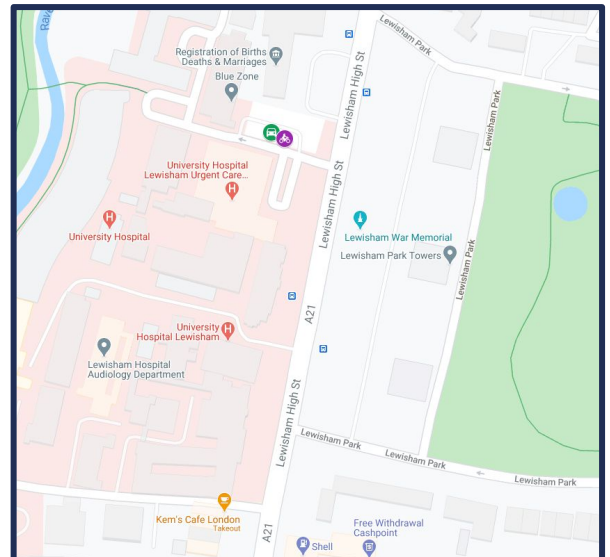

Parking Instructions

Cars & Bikes: Park in car park opposite drop-off / pick-up

Video:

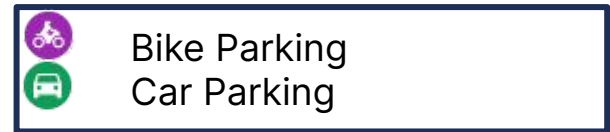

Access Instructions

Return to Lewisham High St and turn right. Enter first road and towards left building "Pink Zone". Enter double doors left of dermatology. Use intercom on door on right once inside. Use lifts to go to 1st floor. Across lift is pathology

<https://www.lewishamandgreenwich.nhs.uk/download.cfm?doc=docm93jijm4n2716>

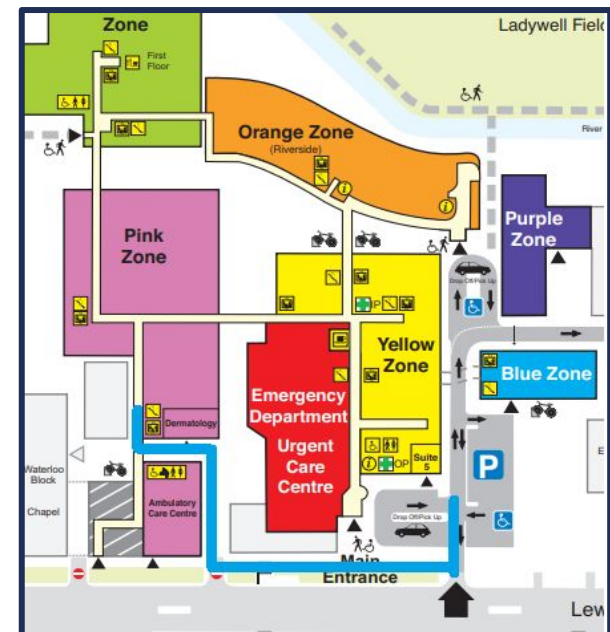



University Hospital Lewisham (Milk)



Key Information

NICU: Green Zone, 4th floor
Postcode: SE13 6LH
Parking W3W: [///stage.labels.exams](http://stage.labels.exams)

Lat & Long: 51.45308 / -0.01672
Pathology Tel: 020 8333 3000

<https://goo.gl/maps/mTsQVzhhWbqqEY618>

ULEZ Zone

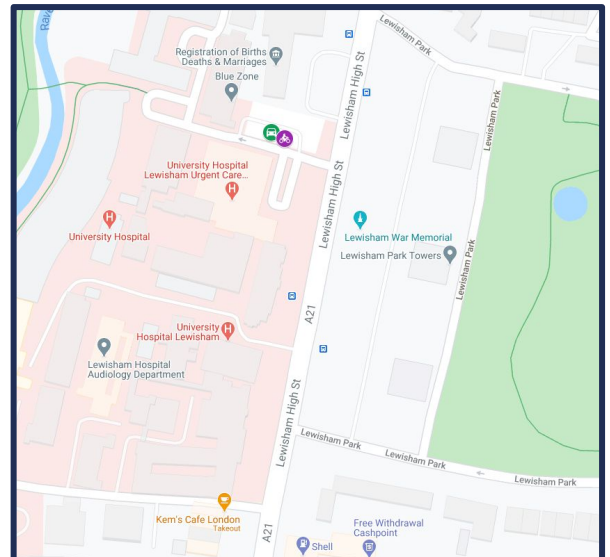

Parking Instructions

Video:

Access Instructions

Enter Green Zone, take lift to 4th floor

<https://www.lewishamandgreenwich.nhs.uk/download.cfm?doc=docm93jijm4n2716>

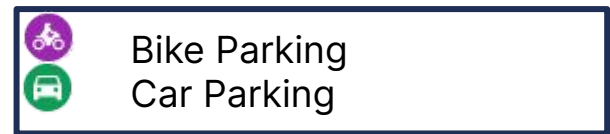



Queen Charlotte's and Chelsea Hospital (Milk)



Key Information

Pathology: Pathology building & floor
Postcode: W12 0HS
Parking W3W: ///varieties.smashes.cheeks

Lat & Long: 51.51637 / -0.23741
Pathology Tel: 020 3313 3559

<https://goo.gl/maps/kLU2B9ExRrPSKGP28>

ULEZ Zone

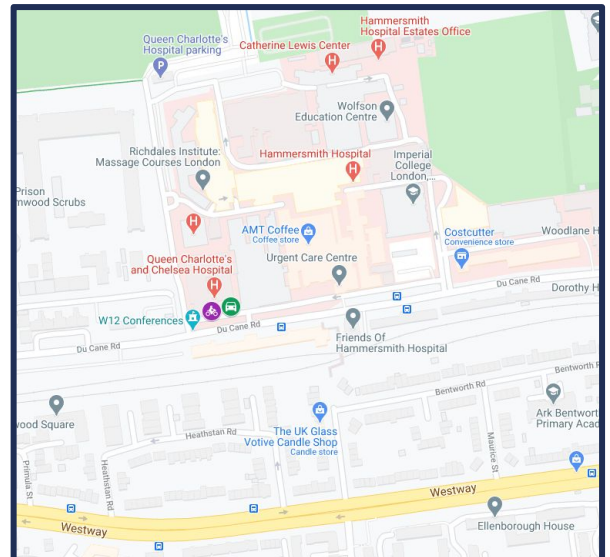

Parking Instructions

Cars & Bikes: Park outside main entrance

Video: <https://youtu.be/T1gOpq7ZzQY>

 **Bike Parking**
 **Car Parking**

Access Instructions

Call the hospital contact on email upon arrival. Enter main entrance and turn right. Head straight to the end of the corridor to the lifts. Go to 4th floor and turn left out of lift, there is a door where contact will meet you

https://www.imperial.nhs.uk/~/_/media/website/locations/queen-charlottes-and-chelsea-hospital/queen-charlottes-and-chelsea-hospital-location-map.pdf?la=en

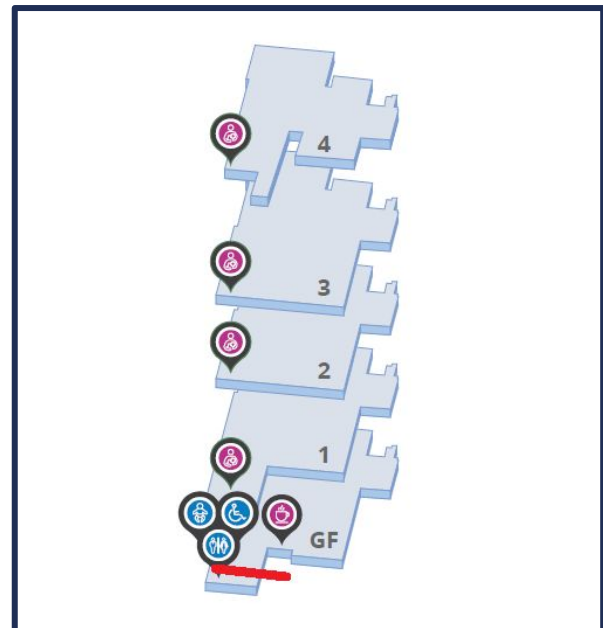



The Royal Marsden Hospital, Surrey (Sample)



Key Information

Pathology: Main building, ground floor
Postcode: SM2 5PT
Parking W3W: ///custom.loud.pose

Lat & Long: 51.34317 / -0.19134
Pathology Tel: 020 8642 6011

<https://goo.gl/maps/6XTgthLWZVhFLeLs5>

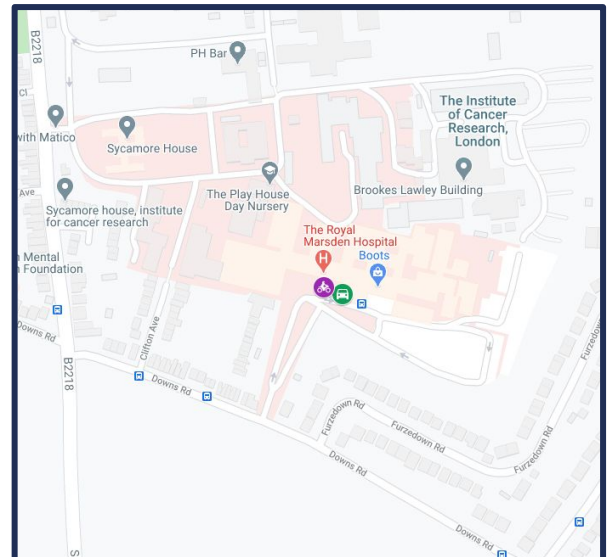

Parking Instructions

Cars & Bikes: Park outside and left of main entrance, in one of "vehicle transport only" bay

Video: <https://youtu.be/sJOuLedNnBQ>



Bike Parking
Car Parking

Access Instructions

Use intercom on left of main entrance doors. In hallway turn left and up ramp. Switchboard office is on left, deliver consignment to switchboard.

https://shared-d7-royalmarsden-publicne-live.s3.amazonaws.com/files_trust/s3fs-public/sutton-map.pdf





Center For Molecular Pathology, Surrey (The Royal Marsden Hospital)



Key Information

Pathology: Center For Molecular Pathology, 1st floor

Postcode: SM2 5PT

Parking W3W: ///tilt.damp.eagle

Lat & Long: 51.344307 / -0.19133
Pathology Tel:

<https://goo.gl/maps/6XTgthLWZVhFLeLs5>

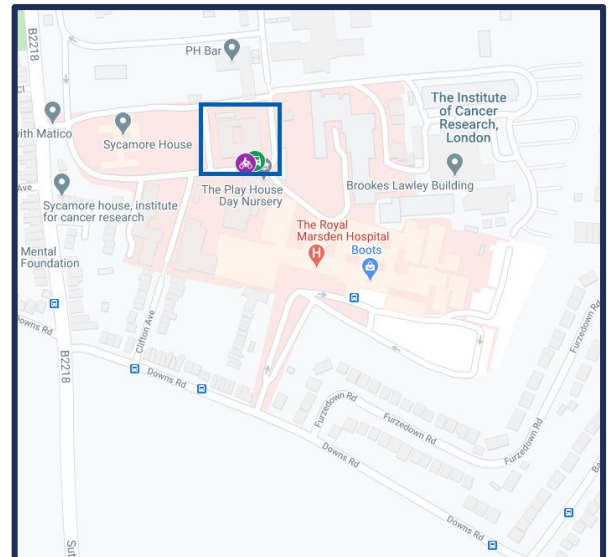
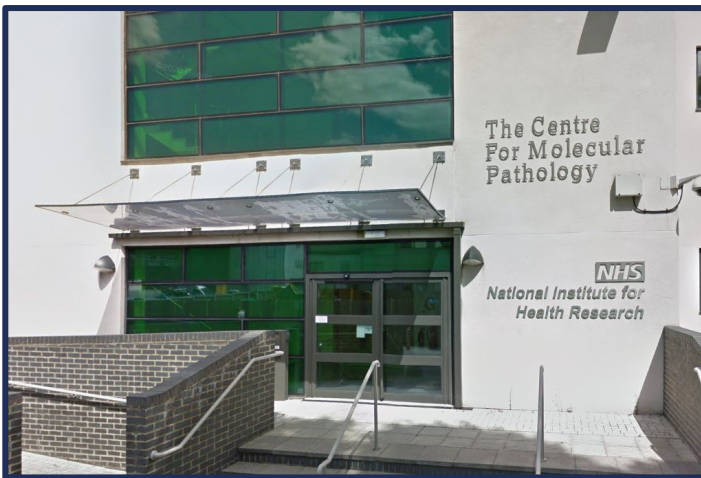

Parking Instructions

Cars & Bikes: Park outside entrance for Centre For Molecular Pathology

Video: <https://youtu.be/x9WAW3jPxyA>



Bike Parking
Car Parking

Access Instructions

Take stairs to first floor. Call lab using list and phone on wall

https://d1joxngr27nfi.cloudfront.net/images/default-source/page-images-labrary/about-us/sutton-map_3fe12744-cc32-45e7-bcad-96451452161b.jpg?sfvrsn=9d1a9868_2

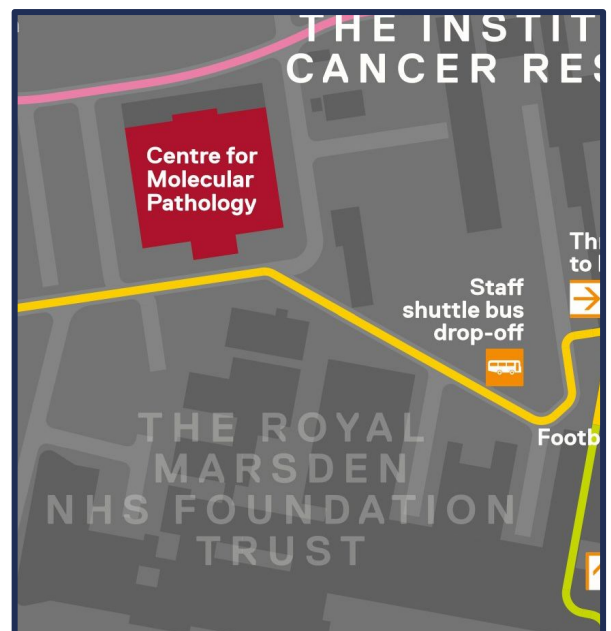



NHSBT, Colindale



Key Information

Hatch: Ground floor
Postcode: NW9 5BG
Parking W3W: [/////stiff.accent.glow](http://stiff.accent.glow)

Lat & Long: 51.595672 / -0.256465
Pathology Tel:

<https://goo.gl/maps/AAjVoFvSBrCUH5mA8>

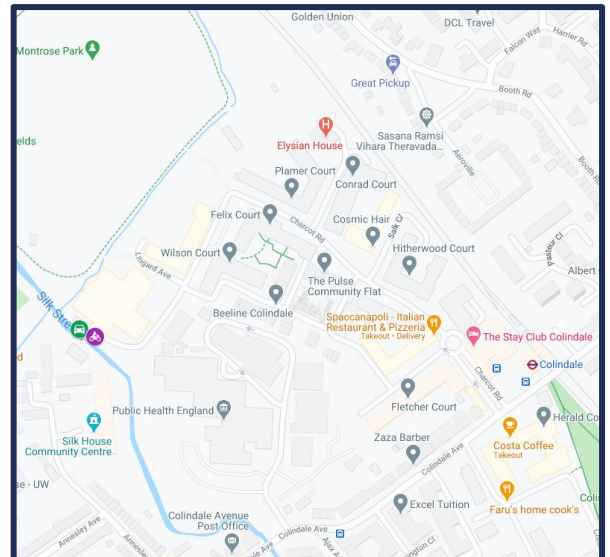

Parking Instructions

Enter via Charcot Road next to Underground station. Follow road around until gates above. Use intercom and state delivery or collection. Follow road to right, park outside warehouse entrance
Video: https://youtu.be/TmAz_iCu_G4



Access Instructions

Hatch is next to warehouse entrance, up the steps. Buzz and manually open hatch.

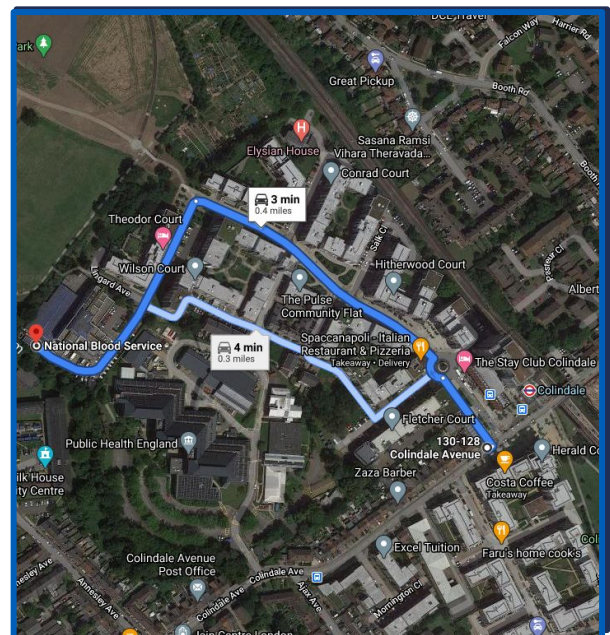

No map available



Doctors' Lab



Key Information

Pathology: Ask reception - floor varies
Postcode: W1T 4EU
Parking W3W: FRONT: [///slime.catch.caged](https://slime.catch.caged)

Lat & Long: 51.5216 / -0.13606
Pathology Tel: -

<https://goo.gl/maps/NNtdSqYhqXnzpe848>

CC Zone | ULEZ Zone

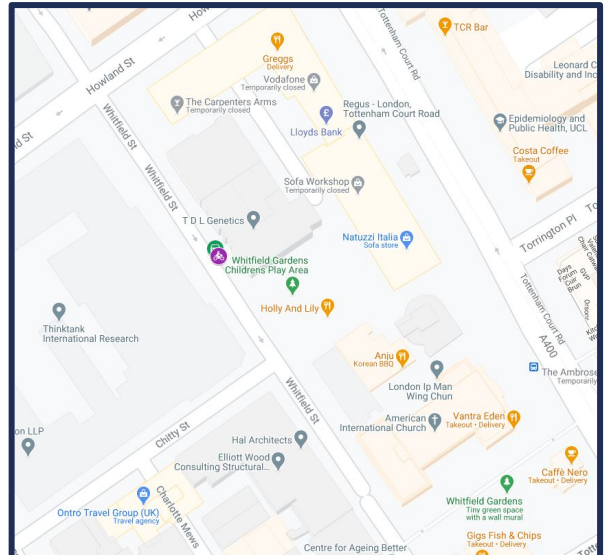
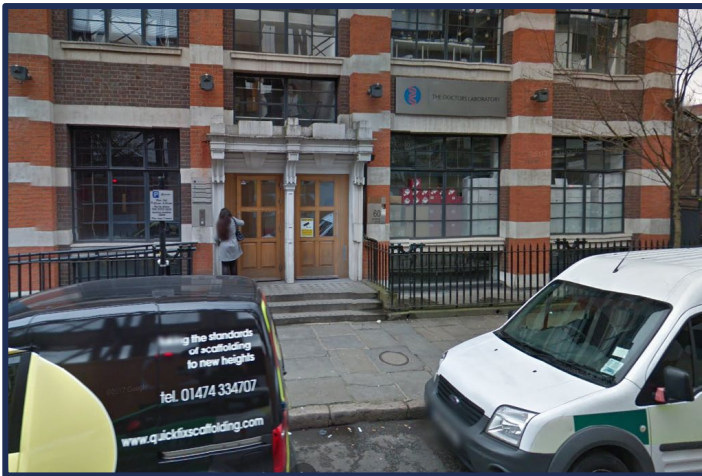

Parking Instructions

Park outside door



See also: *HSL documentation*

Video:

Access Instructions

FRONT: Ring doorbell on left of door. Enter and speak to receptionist at ground floor. They will instruct you on which floor to deliver at

No map available

 **Bike Parking**
 **Car Parking**

No map available



Queen Elizabeth Hospital



Key Information

Pathology: West Entrance, ground floor
Postcode: SE18 4QH
Parking W3W: ///hidden.case.legend

Lat & Long: 51.477647 / 0.049229
Pathology Tel: TBC

<https://goo.gl/maps/UDdDD2ctsdiCUf8t8>

ULEZ Zone

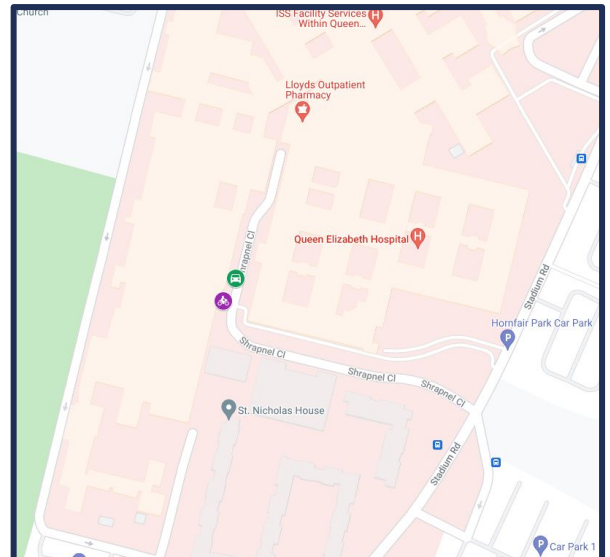
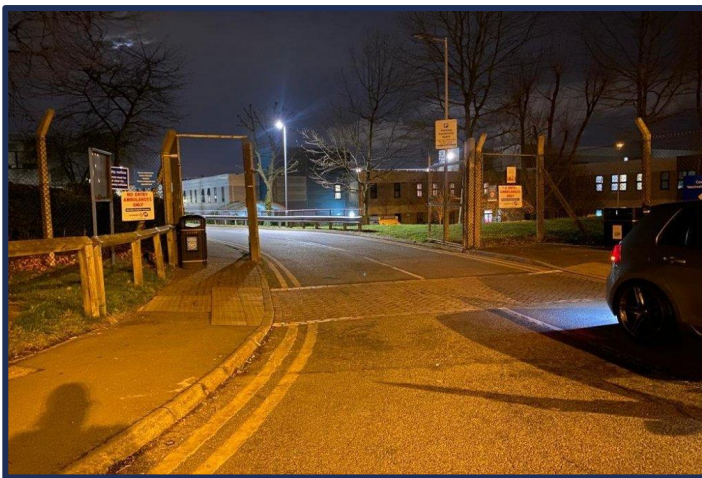

Parking Instructions

Enter Sharpnel Close from Stadium Road, disregarding "ambulance only".

Park outside West Entrance on Shrapnel Close. Bikes - park under canopy. Cars - park outside of hatched yellow area

Video:

 **Bike Parking**
 **Car Parking**

Access Instructions

Enter West Entrance, using buzzer on right if needed. Blood Bank is immediately on the left once inside, use buzzer right of door, wait inside reception behind door

<https://www.lewishamandgreenwich.nhs.uk/download.cfm?doc=docm93jijm4n4296.pdf&ver=5373>

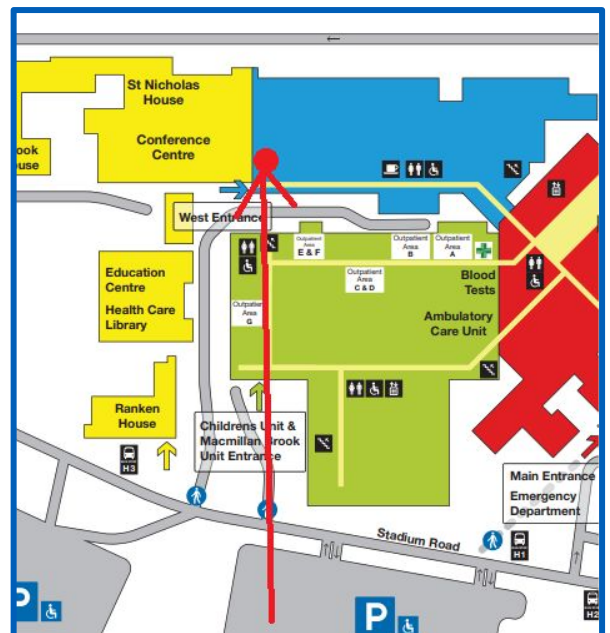



Changelog - latest entry on top

- 2022-02-21 [Samson]
 - Added ULEZ to Queen Elizabeth Hospital - thank you Tim Rice
- 2022-02-08 [Samson]
 - Added page for Queen Elizabeth Hospital, with thanks to Keerat Mudhar for verification
- 2022-01-24 [Samson]
 - Edited W3W for Croydon to better reflect side door location, thanks to Crispin White for the updated link
- 2021-12-01 [Samson]
 - Added ULEZ to the following hospitals: Royal London Hospital, King's College Hospital, Royal Brompton Hospital, Charing Cross Hospital, Chelsea & Westminster Hospital (Milk), St Mary's Hospital (Milk), University Hospital Lewisham, Whipps Cross University Hospital, Queen Charlotte's and Chelsea Hospital (Milk)
 - Updated with new branding
- 2021-09-01 [Samson]
 - Added bleep number to KCH from Geoff Streeter
- 2021-07-29 [Samson]
 - Added longitude and latitude for Kingston Satellite... site, thanks to Tim Rice for the L&L
- 2021-06-28 [Samson]
 - Added instructions to St Thomas' in case the doors outside lift core 5 are locked as reported by Mike Coombes
- 2021-06-28 [Samson]
 - Minor edit to remove number of steps in Colindale as reported by Nic Varley and Angus Cleaver
 - Harefield parking for cars updated from Nic Varley - the volunteers bayts are gone
 - New parking and access direction for Croydon - FINALLY! - lots of verification and hands here, Steve Cripps gets extra special mention, but many hands helped here
- 2021-05-24 [Samson]
 - Updated KCH path number found by Mike Ney
- 2021-04-25 [Samson]
 - Updated St Peters with new instructions from Graeme Donnelly - The new doorbell!
 - Also added new Youtube videos from Steve Cripps to St Peters
 - Updated Hillingdon with new instructions and parking from Nic Taylor
- 2021-03-28 [Samson]
 - Added new Youtube videos from Steve Cripps, edited existing links and added new links for Croydon University Hospital
 - Doctor's Lab and Health Sciences Lab are now separate documents - Doctor's Lab is "front" and HSL is "back"
- 2021-03-25 [Samson]
 - Added new Youtube videos from Steve Cripps, edited existing links and added new links for NBS Colindale
- 2021-01-20 [Samson]
 - Edited Epsom with new number from Steve Cripps
 - Edited St Helier with new number from Steve Cripps
- 2021-01-19 [Samson]
 - Edited GOSH with correct parking map (spotted by Will Brooks)
 - Edited Harefield's Long/Lat with a - before Lat (spotted by Will Brooks)
- 2021-01-18 [Samson]
 - Edited St Peters with a new Pathology number from Steve Cripps

Continued...

Please send feedback & inaccuracies to: press@servssl.org.uk



Changelog - latest entry on top

- 2021-01-12 [Samson]
 - Edited Croydon University Hospital with new access instruction from myself
 - Added new Youtube videos from Steve Cripps, edited existing links and added new links:
 - St Thomas'
 - Royal Brompton
 - Guys
 - Center For Molecular Pathology, Surrey (The Royal Marsden Hospital)
 - Queen Charlotte's and Chelsea Hospital (Milk)
- 2020-12-27 [Samson]
 - Edited Croydon University Hospital with new access instruction from Martin Whitehead
- 2020-12-20 [Samson]
 - Edited St George's with correct map (spotted by Chris Butler)
- 2020-12-18 [Samson]
 - Edited St Mary's with updates from John Harmon
- 2020-12-13 [Samson]
 - Added new Youtube videos from Steve Cripps, edited existing links and added new links
 - Minor wording edits
 - Edited East Surrey Hospital with updates from Chris Butler
 - Added The Royal Marsden Hospital, Surrey
 - Added NHSBT Colindale
 - Added Center For Molecular Pathology, Surrey (The Royal Marsden Hospital)
- 2020-11-27 [Samson]
 - Changed photo for QCC from Steve Cripps